

BOARD OF SUPERVISORS

MADISON COUNTY, MISSISSIPPI

Department of Engineering
Tim Bryan, P.E., County Engineer

3137 South Liberty Street, Canton, MS 39046
Office (601) 790-2525 FAX (601) 859-3430

MEMORANDUM

June 21, 2023

To: Sheila Jones, Supervisor, District I
Trey Baxter, Supervisor, District II
Gerald Steen, Supervisor, District III
Karl Banks, Supervisor, District IV
Paul Griffin, Supervisor, District V

From: Tim Bryan, P.E., PTOE
County Engineer

Re: Comcast Cable Utility Permit
County Road Name, Endris Road, Gunter Road, Gunter Lane and Old Natchez Trace

The Engineering Department recommends approval of the permit application for Comcast Cable is attaching 24 CT and 48 CT fiber to existing poles, boring and installing 2" HDPE to pull 48 CT and 24 CT fiber within the right-of-way owned by the County including the listed roads below.

- Endris Road
- Gunter Road
- Gunter Lane
- And Old Natchez Trace

SHEILA JONES
District One

TREY BAXTER
District Two

GERALD STEEN
District Three

KARL BANKS
District Four

PAUL GRIFFIN
District Five

Revised: 2/14/2019



PERMIT APPLICATION FOR THE CONSTRUCTION OR ADJUSTMENT OF A UTILITY WITHIN COUNTY ROAD RIGHT-OF-WAY

Utility Information: Utility Name: COMCAST CABLE

Address: 3425 Malone Drive City/State/Zip: Chamblee/ GA/ 30-341

Contact Person: Linda Taibl Contact's Phone: _____

Project Information: County Road Name: Endris Rd, Gunter Rd, Gunter Ln, Old Natchez Trce, Old Natchez Cv
(If located within more than one road right-of-way, use Appendix 1 for additional descriptions)

Beginning Location: 32.574845, -89.969682 Ending Location: 32.545804, -89.951865

Length of Project: 19637FT Section: 34 Township: 3 Range: 69

Description of Work: COMCAST IS ATTACHING 24CT AND 48CT FIBER TO EXISTING POLES, BORING AND INSTALLING 2" HDPE TO PULL 48CT AND 24CT FIBER WITHIN THE RIGHT-OF-WAY OWNED BY THE COUNTY.

TOTAL INSTALLATION LENGTH IN ROW: 19637FT

Check Box if Appendix 1 is to be included as a part of this Application

Whereas the above stated Utility makes application to the **Madison County Board of Supervisors** for a Construction Permit. Attached hereto are drawings and plans for the construction of the above facilities located within Madison County owned public rights-of-way. Once stamped by the Madison County Engineering Department, these plans shall not be changed or altered without written approval of the County Engineer, or his representative. A copy of the approved permit and plans shall be on-site at all times during construction.

The Applicant Utility shall comply with all policies, procedures and construction practices as outlined in *A Policy for The Accommodation of Utility Facilities within the Right-of-Way of all Public County Roads* (hereinafter referred to as the "Policy"), as adopted on November 1, 2005, by the **Madison County Board of Supervisors**, and which is hereby made a part of this Application Agreement.

If facilities are to be located within the Rights-of-Way of the County-Federal or State Aid System, Applicant Utility also agrees to comply with applicable provisions of *S.O.P. No. SA II-2-8, Accommodation of Utilities on Rights-of-Way*, issued by the State Aid Engineer and dated July 1, 2005.

The Applicant Utility understands and agrees that, except as herein granted, no right, title, claim, or easement to said road right-of-way is granted by the issuance of this permit. If this Utility is listed in the general provisions of the Policy, it will be adjusted to comply with same without cost to the County, unless the variance from the Policy has been approved by the granting of the Permit pursuant to this Application.

The Applicant Utility further understands that the Utility's engineering, plant, or other personnel will be responsible for the staking and construction supervision of the work set out above and as shown on the attached plans. If work impacts traffic in any way, the appropriate traffic control shall be installed per the *Manual of Uniform Traffic Control Devices*, Latest Edition.

The Applicant Utility understands that the County Engineer, or his representative, may issue a Stop Work Order at any time if it is deemed that site conditions are not suitable for construction or if any of the requirements of this permit are not being met.

Many County Roads have variable Rights-of-Way and/or no Right-of-Way at all and are maintained under a Prescriptive Easement. It is the sole responsibility of the Applicant Utility to verify the existence and limits of public rights-of-way. If none exists, it is the

responsibility of the Applicant Utility to acquire an easement for their Facilities from the applicable property owner(s). Madison County in no way verifies the limits of Right-of-Way as shown on the permit application.

The Applicant Utility shall be responsible for all future maintenance and repair of the facilities installed under this permit. The Applicant Utility shall make future adjustments to, or relocate, the facilities located within road or highway right-of-way when required for road or highway widening or other road or highway construction at no cost to Madison County. The Applicant Utility shall relocate said utilities within sixty (60) days of notification by County by registered mail, return receipt requested, unless otherwise designated by the County Engineer. Further, any maintenance, repair, or construction shall be done in such a manner as to occasion no unreasonable interference with the normal flow and safety to traffic and at the expense of the utility company. When reasonable care has been taken to locate said utility facilities within the right-of-way, the Applicant Utility understands that any damages caused by routine maintenance and construction by County forces shall be borne by the Applicant Utility.

The Applicant Utility further agrees to indemnify and hold Madison County harmless for any and all claims, accidents, damages, liabilities and expenses occasioned wholly, or in part, by any act or omission of applicant, its agents or employees. In case County shall, without fault on its own part, be made a party to any litigation commenced by or against applicant, then applicant shall protect and hold County harmless, and shall pay all costs, expenses and reasonable attorney's fees incurred or paid by County in connection with said litigation.

All underground facilities shall be installed at a depth equal to or greater than 48" below the lowest adjacent grade.

All pipes carrying liquid shall be encased under County maintained roads.

WITNESS the signature of the Applicant this the 24 day of 05, 2023.

By: Linda Taibl
(Applicant Signature)

Title: Construction specialist

Note: Applicant must be an employee of the Utility named in this application. The Madison County Board of Supervisors will not recognize a Contractor, Subcontractor, Agent, or Consulting Engineer as the Applicant. Utility Company shall be fully responsible for all work performed under this application.

I, or my authorized representative, have reviewed this application and determined that the drawing, sketches, and plans submitted by the Applicant meet the requirements of A Policy for The Accommodation of Utility Facilities within the Right-of-Way of all Public County Roads.

* County Approval does not apply to Old Natchez Cv.

APPROVED

By: **By timothy.bryan at 12:30 pm, Jun 27, 2023**

Tim Bryan, P.E. BJ
County Engineer

AGREED TO AND APPROVED BY:

Madison County Board President

Date: _____

ENTERED INTO THE MINUTES OF THE BOARD OF SUPERVISORS OF MADISON COUNTY, MISSISSIPPI ON THIS

____ DAY OF _____, 20____.

Appendix 1

County Road Name: Endris Rd
Beginning Location: 32.574845, -89.969682 Ending Location: 32.559758, -89.969555
Length of Project: 3206FT Section: 34 Township: 3 Range: 69
Description of Work: ATTACH NEW 24CT AND 48CT FIBER TO EXISTING POLES, BORE AND INSTALL 2" HDPE TO PULL NEW 48CT FIBER WITHIN THE ENDRISE RD RIGHT-OF WAY.

County Road Name: Gunter Rd
Beginning Location: 32.567682, -89.969357 Ending Location: 32.545793, -89.952378
Length of Project: 12242FT Section: 34 Township: 3 Range: 69
Description of Work: ATTACH NEW 24CT FIBER TO EXISTING POLES, BORE AND INSTALL 2" HDPE TO PULL NEW 24CT AND 48CT FIBER WITHIN THE GUNTER RD RIGHT-OF WAY.

County Road Name: Gunter Ln
Beginning Location: 32.564202, -89.960982 Ending Location: 32.557507, -89.960912
Length of Project: 1898FT Section: 34 Township: 3 Range: 69
Description of Work: ATTACH NEW 24CT AND 48CT FIBER TO EXISTING POLES, BORE AND INSTALL 2" HDPE TO PULL NEW 48CT FIBER WITHIN THE GUNTER LN RIGHT-OF WAY.

County Road Name: Old Natchez Trce
Beginning Location: 32.545793, -89.952378 Ending Location: 32.545795, -89.951818
Length of Project: 170FT Section: 34 Township: 3 Range: 69
Description of Work: BORE AND INSTALL 2" HDPE TO PULL NEW 24CT FIBER WITHIN THE OLD NATCHEZ TRCE RIGHT-OF-WAY.

County Road Name: Old Natchez Cv
Beginning Location: 32.556767, -89.952711 Ending Location: 32.561163, -89.949740
Length of Project: 2121FT Section: 34 Township: 3 Range: 69
Description of Work: BORE AND INSTALL 2" HDPE TO PULL NEW 24CT FIBER WITHIN THE OLD NATCHEZ CV RIGHT-OF-WAY.



PREPARED BY:



QUASAR, INC.

COMCAST IS ATTACHING FIBER TO EXISTING
POLES, BORING AND INSTALLING NEW CONDUIT WITHIN
THE RIGHT-OF-WAY OWNED BY THE COUNTY.
TOTAL: 19637ft

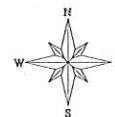

NO SCALE

ENGINEERED FOR:



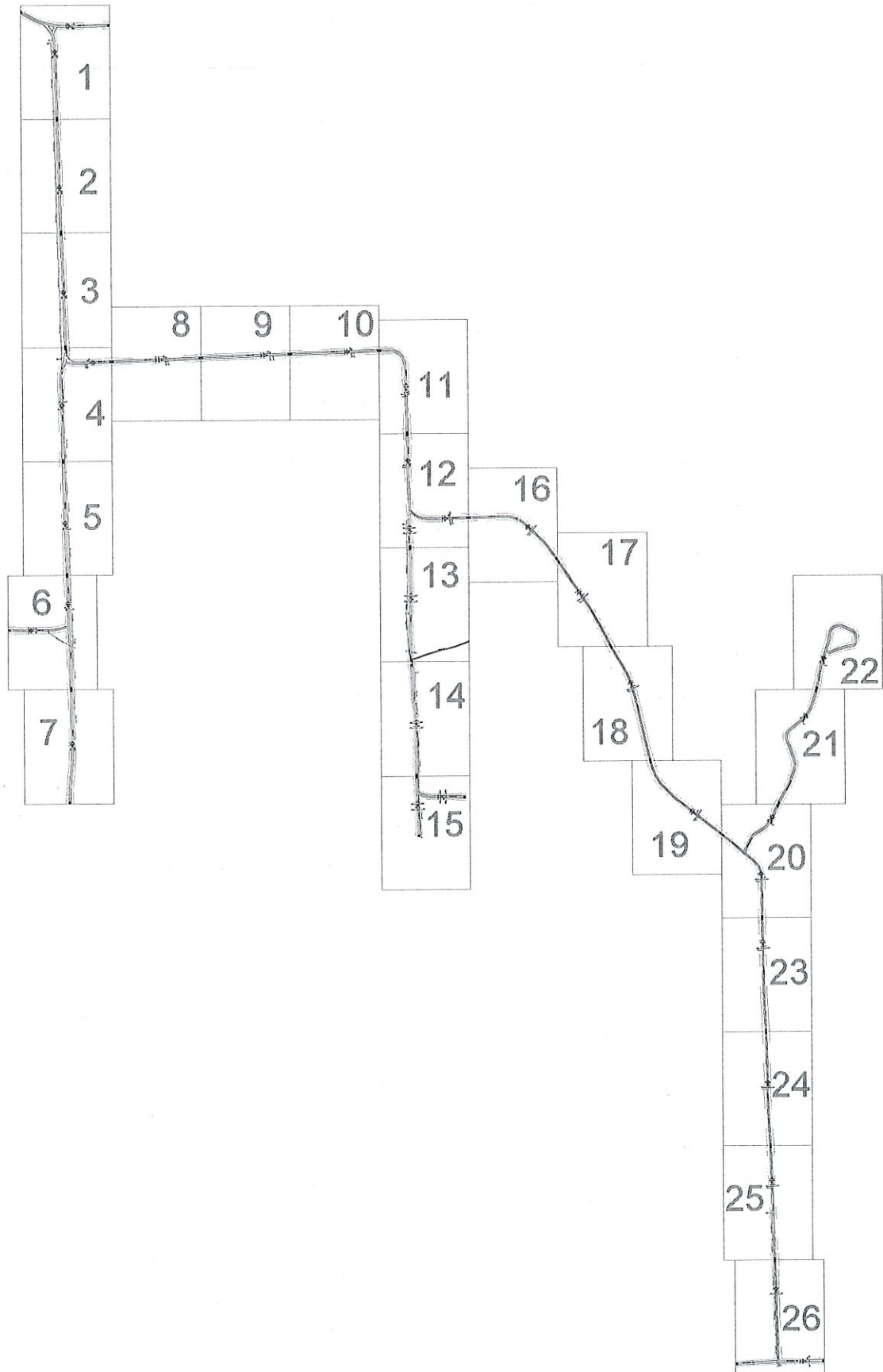

PREPARED BY:



COMCAST IS ATTACHING FIBER TO EXISTING
POLES, BORING AND INSTALLING NEW CONDUIT WITHIN
THE RIGHT-OF-WAY OWNED BY THE COUNTY.
TOTAL: 19637ft

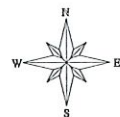

ENGINEERED FOR:



NO SCALE

NO MATCH SHEET

NO MATCH SHEET

NO MATCH SHEET

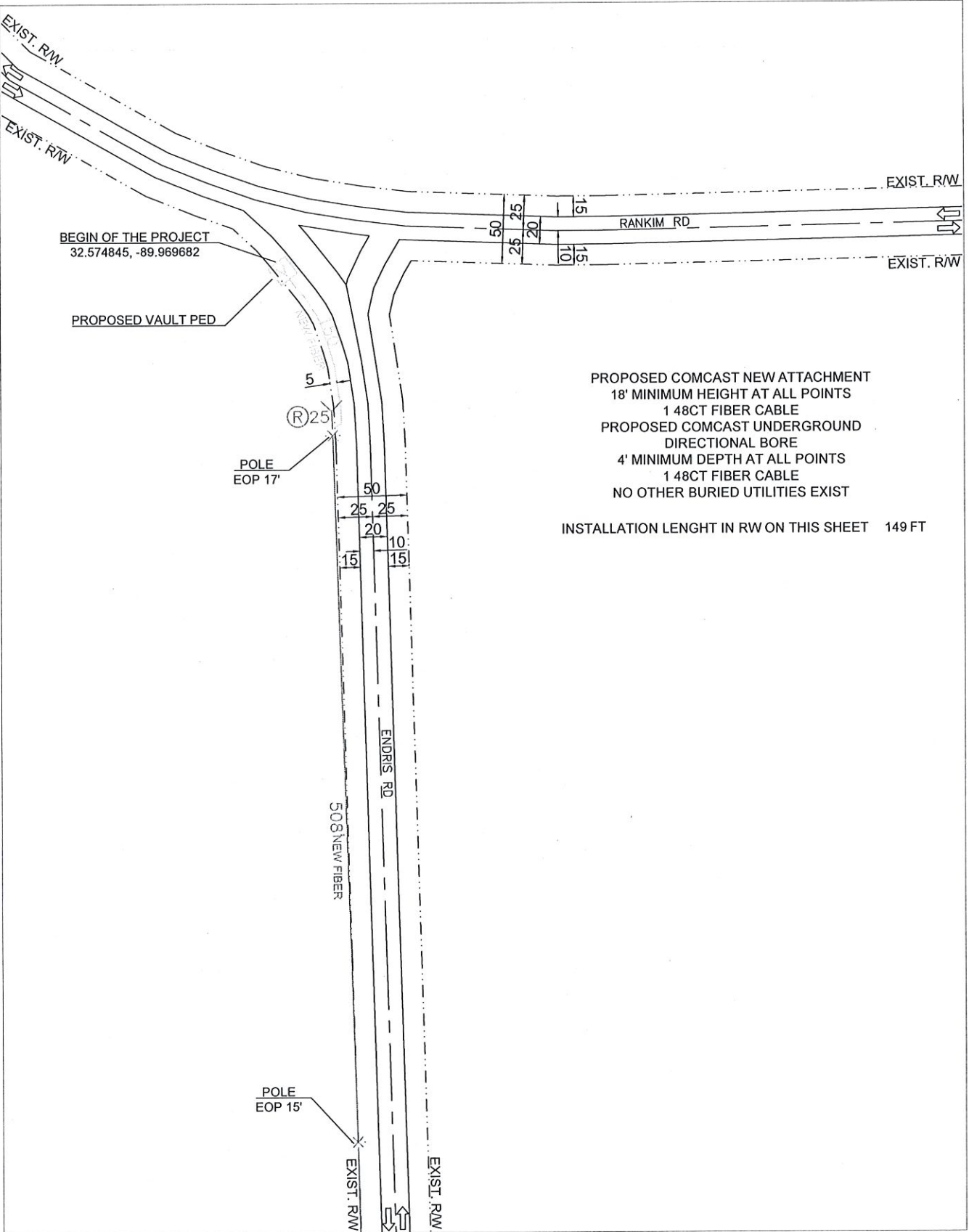

PROPOSED COMCAST NEW ATTACHMENT
 18' MINIMUM HEIGHT AT ALL POINTS
 1 48CT FIBER CABLE
 PROPOSED COMCAST UNDERGROUND
 DIRECTIONAL BORE
 4' MINIMUM DEPTH AT ALL POINTS
 1 48CT FIBER CABLE
 NO OTHER BURIED UTILITIES EXIST
 INSTALLATION LENGHT IN RW ON THIS SHEET 149 FT

MATCH SHEET 2

PREPARED BY: 	EXISTING POLE PROPOSED PEDESTAL PROPOSED VAULT WATER VALVE FIBER MARKER GAS MARKER MANHOLE SEWER MANHOLE STORM DRAIN	RIGHT OF WAY LINE IRRIGATION LINE WATER LANE GAS LANE PROPOSED ANCHOR PROPOSED RISER	PROPOSED COAXIAL CABLE PROPOSED FIBER CABLE PROPOSED DIRECTIONAL BORE EXISTING CABLE COUNTY LINE		ENGINEERED FOR: MADISON COUNTY ENDRIS RD TRANSPORT FIBER		NO SCALE	SHEET 1 OF 26
	LEGEND: RW - RIGHT OF WAY EOP - EDGE OF PAVEMENT DW - DRIVEWAY PDW - PAVED DRIVEWAY	NOTES: BORE HOLE TO BE FILLED SAME DAY VAULT HOLE TO BE FILLED SAME DAY ALL HOLE TO BE TAMPED AND SODDED						

MATCH SHEET 1

PROPOSED COMCAST NEW ATTACHMENT
 18' MINIMUM HEIGHT AT ALL POINTS
 1 48CT FIBER CABLE

INSTALLATION LENGHT IN RW ON THIS SHEET 0 FT

NO MATCH SHEET

NO MATCH SHEET

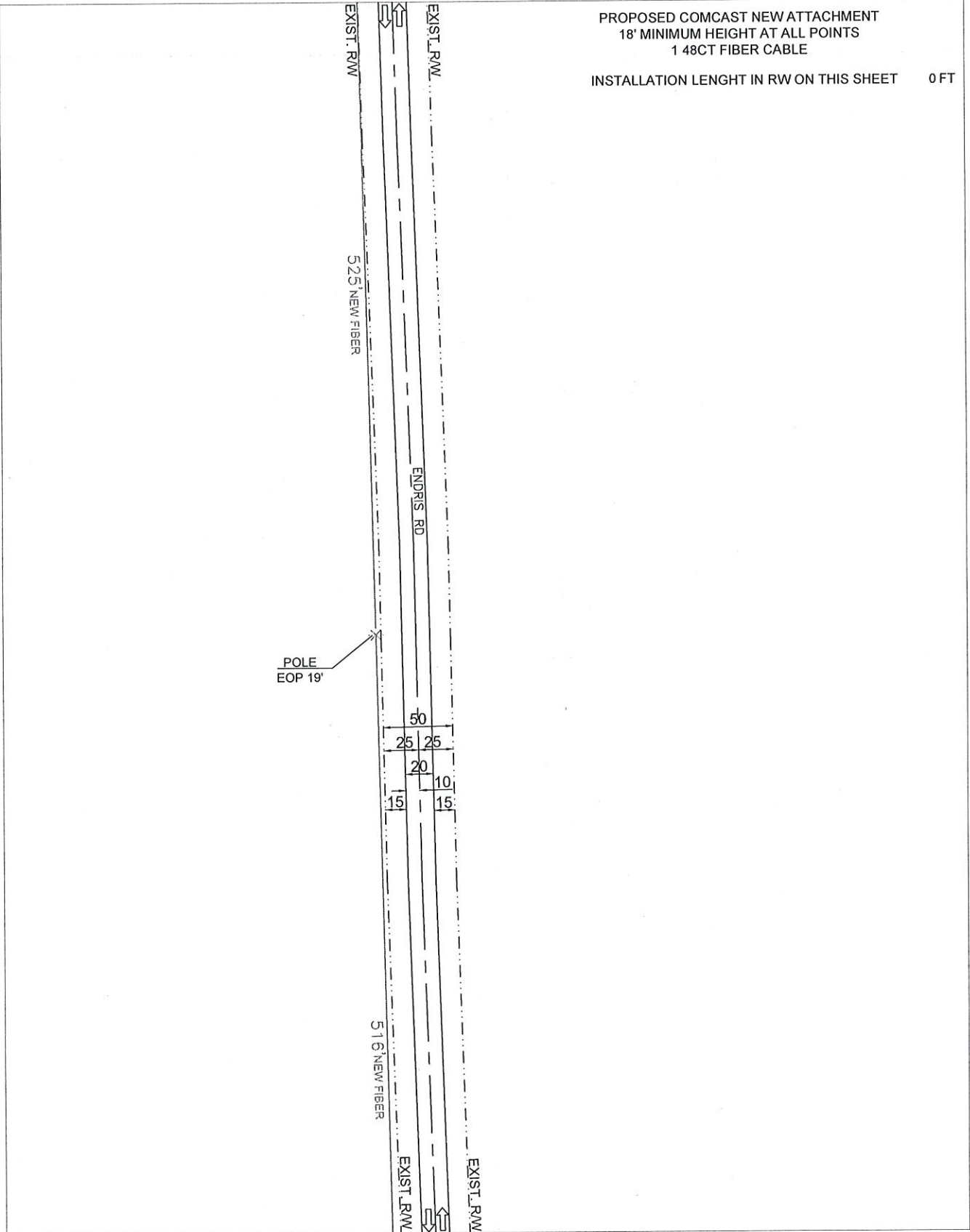

MATCH SHEET 3

PREPARED BY: 	EXISTING POLE PROPOSED PEDESTAL PROPOSED VAULT WATER VALVE FIBER MARKER GAS MARKER MANHOLE SEWER MANHOLE STORM DRAIN	RIGHT OF WAY LINE IRRIGATION LINE WATER LANE GAS LANE PROPOSED ANCHOR PROPOSED RISER	PROPOSED COAXIAL CABLE PROPOSED FIBER CABLE PROPOSED DIRECTIONAL BORE EXISTING CABLE COUNTRY LINE		ENGINEERED FOR: MADISON COUNTY ENDRIS RD TRANSPORT FIBER		NO SCALE	SHEET 2 OF 26
	LEGEND: RW - RIGHT OF WAY EOP - EDGE OF PAVEMENT DW - DRIVEWAY PDW - PAVED DRIVEWAY				NOTES: BORE HOLE TO BE FILLED SAME DAY VAULT HOLE TO BE FILLED SAME DAY ALL HOLE TO BE TAMPED AND SOODED			

MATCH SHEET 2

NO MATCH SHEET

NO MATCH SHEET

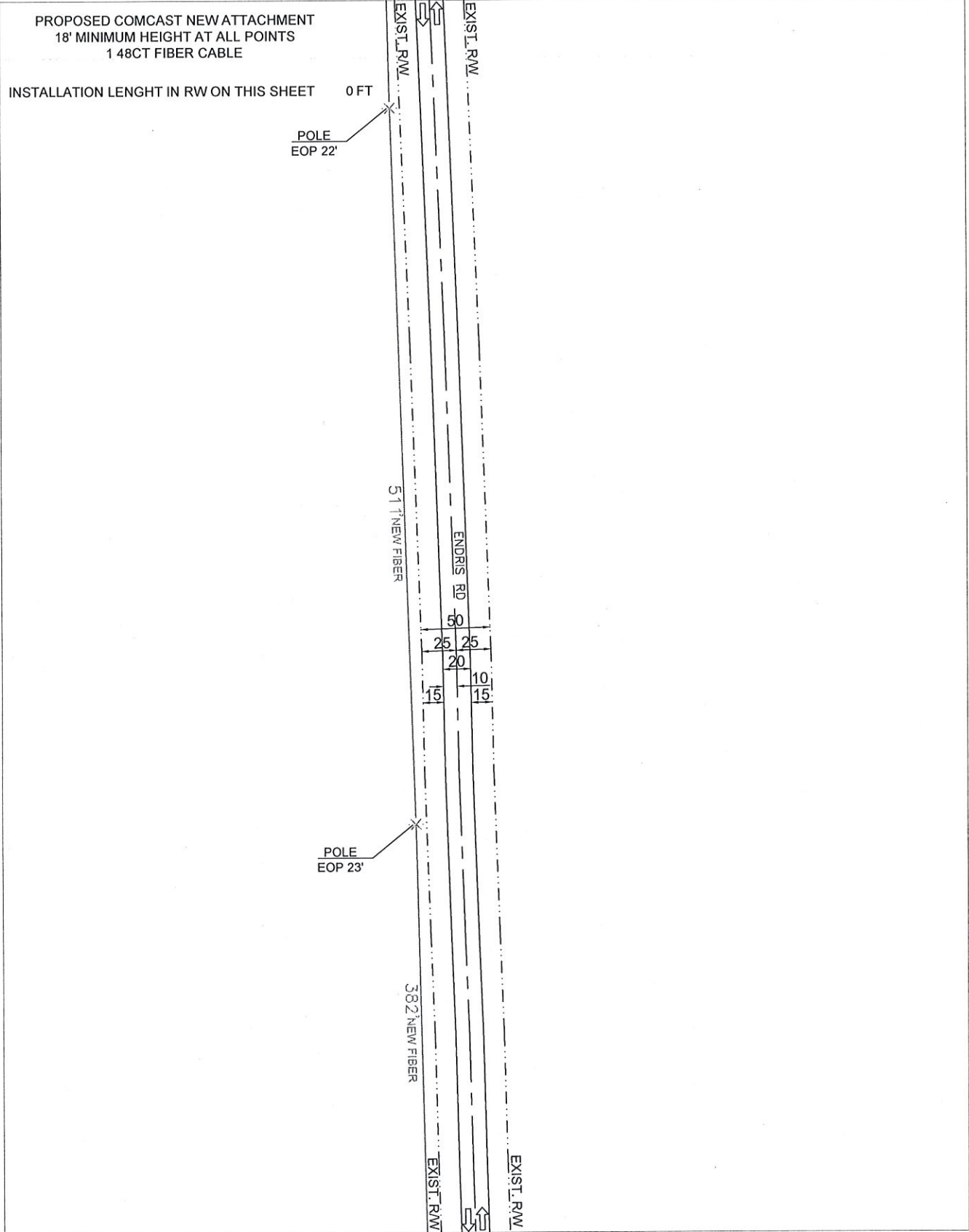

MATCH SHEET 4

PREPARED BY: 	EXISTING POLE PROPOSED PEDESTAL PROPOSED VAULT WATER VALVE FIBER MARKER GAS MARKER MANHOLE SEWER MANHOLE STORM DRAIN	RIGHT OF WAY LINE IRRIGATION LINE WATER LANE GAS LANE PROPOSED ANCHOR PROPOSED RISER LEGEND: RW - RIGHT OF WAY EOP - EDGE OF PAVEMENT DW - DRIVEWAY PDW - PAVED DRIVEWAY	PROPOSED COAXIAL CABLE PROPOSED FIBER CABLE PROPOSED DIRECTIONAL BORE EXISTING CABLE COUNTY LINE		ENGINEERED FOR: MADISON COUNTY ENDRIS RD TRANSPORT FIBER		NO SCALE	SHEET 3 OF 26
	NOTES: BORE HOLE TO BE FILLED SAME DAY VAULT HOLE TO BE FILLED SAME DAY ALL HOLE TO BE TAMPED AND SODDED							

MATCH SHEET 3

MATCH SHEET 9

PROPOSED COMCAST NEW ATTACHMENT
 18' MINIMUM HEIGHT AT ALL POINTS
 1 48CT FIBER CABLE
 PROPOSED COMCAST UNDERGROUND
 DIRECTIONAL BORE
 4' MINIMUM DEPTH AT ALL POINTS
 1 48CT FIBER CABLE
 NO OTHER BURIED UTILITIES EXIST

INSTALLATION LENGTH IN RW ON THIS SHEET 1293 FT

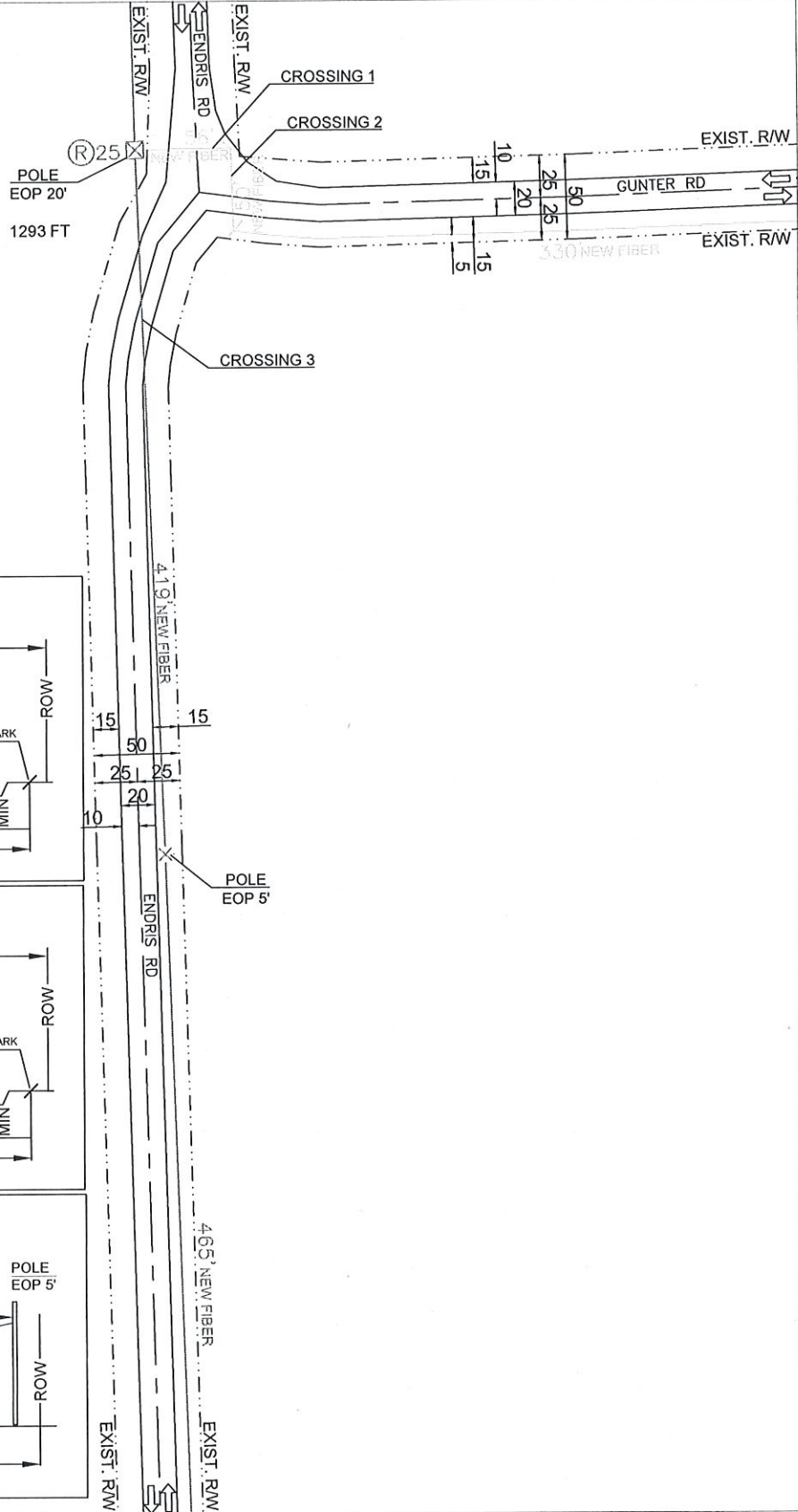

NO MATCH SHEET

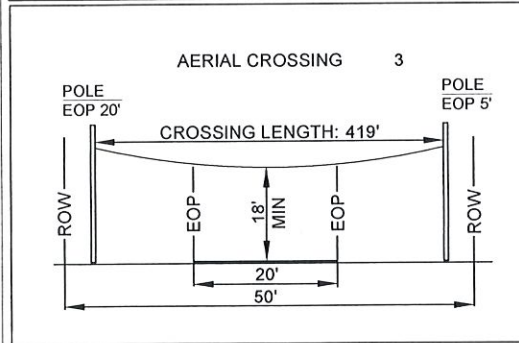
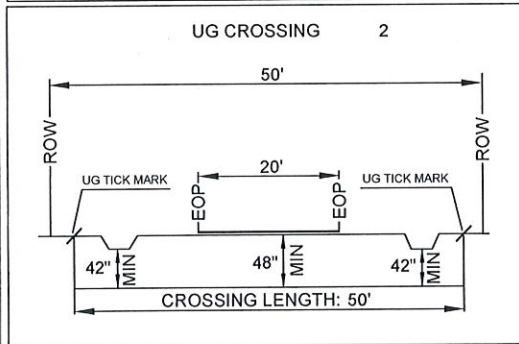
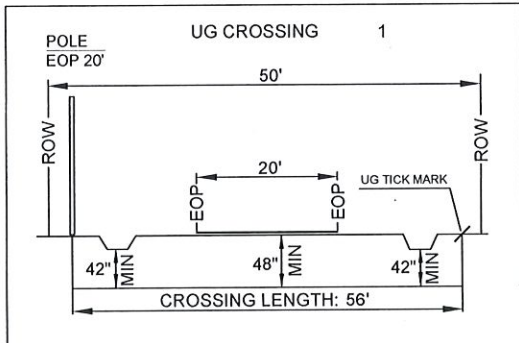

MATCH SHEET 5

PREPARED BY: 	EXISTING POLE PROPOSED PEDESTAL PROPOSED VAULT WATER VALVE FIBER MARKER GAS MARKER MANHOLE SEWER MANHOLE STORM DRAIN	RIGHT OF WAY LINE IRRIGATION LINE WATER LANE GAS LANE PROPOSED ANCHOR PROPOSED RISER	PROPOSED COAXIAL CABLE PROPOSED FIBER CABLE PROPOSED DIRECTIONAL BORE EXISTING CABLE COUNTY LINE		ENGINEERED FOR: 	MADISON COUNTY GUNTER ROAD ENDRIS RD TRANSPORT FIBER
	LEGEND: RW - RIGHT OF WAY EOP - EDGE OF PAVEMENT DW - DRIVEWAY PDW - PAVED DRIVEWAY	NOTES: BORE HOLE TO BE FILLED SAME DAY VAULT HOLE TO BE FILLED SAME DAY ALL HOLE TO BE TAMPED AND SOODED	NO SCALE SHEET 4 OF 26			

MATCH SHEET 4

PROPOSED COMCAST NEW ATTACHMENT
 18' MINIMUM HEIGHT AT ALL POINTS
 1 48CT FIBER CABLE
 INSTALLATION LENGTH IN RW ON THIS SHEET 991 FT

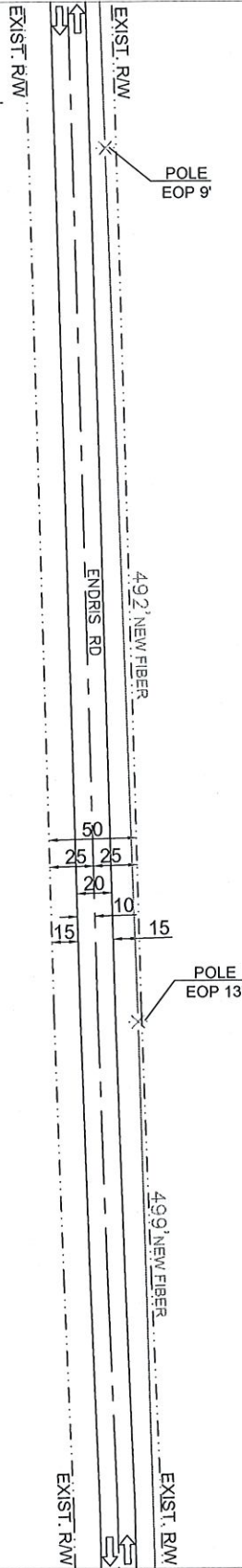

NO MATCH SHEET

NO MATCH SHEET

MATCH SHEET 6

PREPARED BY: 	EXISTING POLE PROPOSED PEDESTAL PROPOSED VAULT WATER VALVE FIBER MARKER GAS MARKER MANHOLE SEWER MANHOLE STORM DRAIN	RIGHT OF WAY LINE IRRIGATION LINE WATER LANE GAS LANE PROPOSED ANCHOR PROPOSED RISER	PROPOSED COAXIAL CABLE PROPOSED FIBER CABLE PROPOSED DIRECTIONAL BORE EXISTING CABLE COUNTY LINE		ENGINEERED FOR: 	MADISON COUNTY ENDRIS RD TRANSPORT FIBER
	LEGEND: RW - RIGHT OF WAY EOP - EDGE OF PAVEMENT DW - DRIVEWAY PDW - PAVED DRIVEWAY				NOTES: BORE HOLE TO BE FILLED SAME DAY VAULT HOLE TO BE FILLED SAME DAY ALL HOLE TO BE TAMPED AND SODDED	NO SCALE SHEET 5 OF 26

MATCH SHEET 5

PROPOSED COMCAST NEW ATTACHMENT
 18' MINIMUM HEIGHT AT ALL POINTS
 1 24CT FIBER CABLE
 1 48CT FIBER CABLE

INSTALLATION LENGTH IN RW ON THIS SHEET 868 FT

NO MATCH SHEET

NO MATCH SHEET

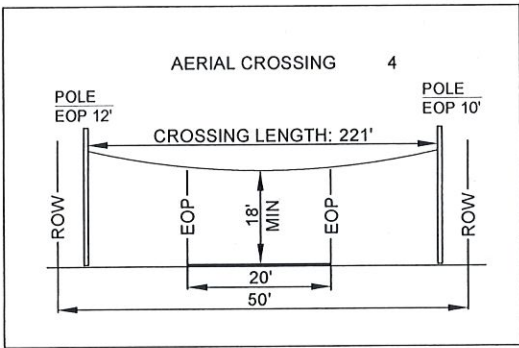
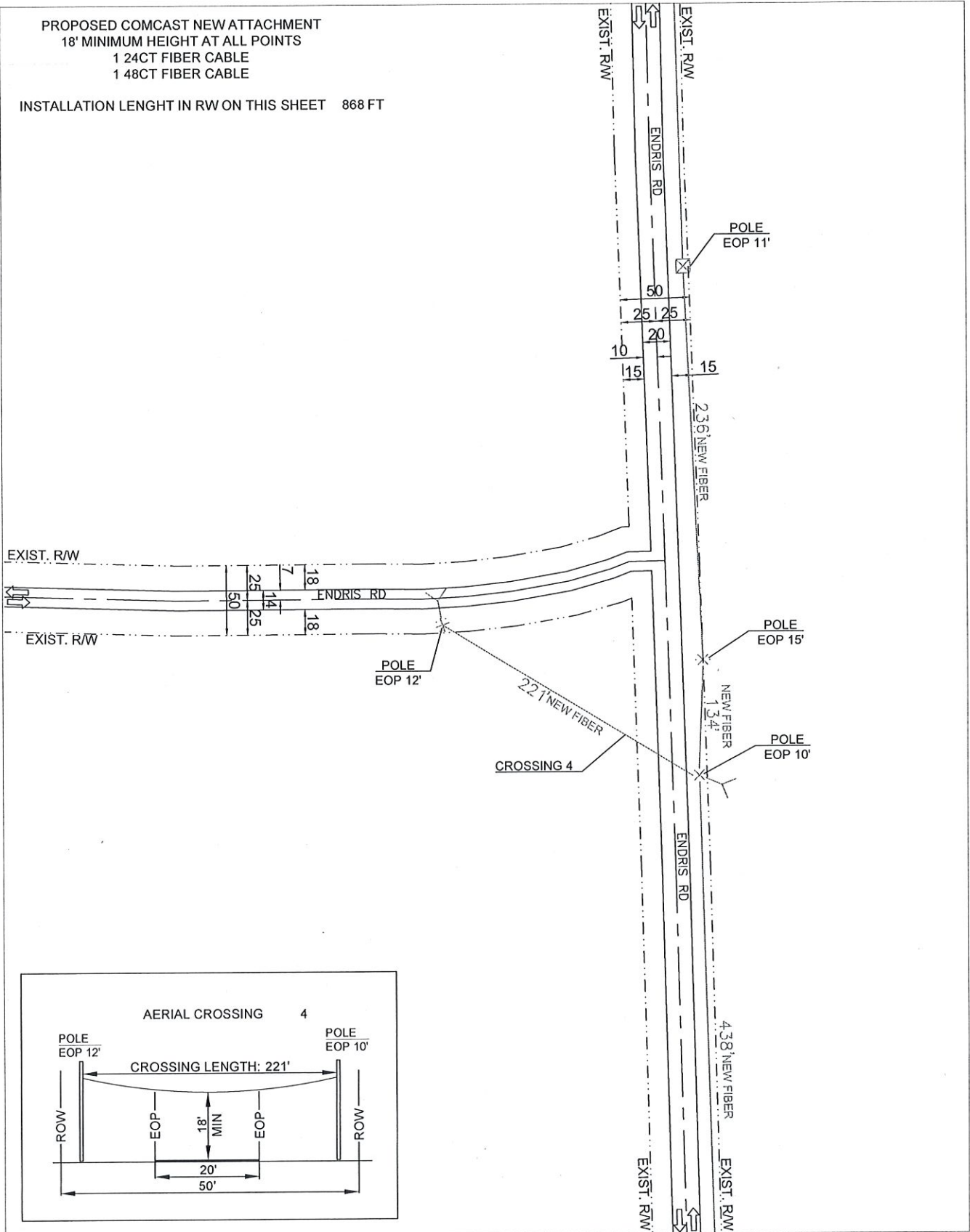

MATCH SHEET 7

PREPARED BY: 	EXISTING POLE PROPOSED PEDESTAL PROPOSED VAULT WATER VALVE FIBER MARKER GAS MARKER MANHOLE SEWER MANHOLE STORM DRAIN	RIGHT OF WAY LINE IRRIGATION LINE WATER LAINE GAS LAINE PROPOSED ANCHOR PROPOSED RISER	PROPOSED COAXIAL CABLE PROPOSED FIBER CABLE PROPOSED DIRECTIONAL BORE EXISTING CABLE COUNTY LINE		ENGINEERED FOR: MADISON COUNTY ENDRIS RD TRANSPORT FIBER		NO SCALE	SHEET 6 OF 26
	LEGEND: RW - RIGHT OF WAY EOP - EDGE OF PAVEMENT DW - DRIVEWAY POW - PAVED DRIVEWAY	NOTES: BORE HOLE TO BE FILLED SAME DAY VAULT HOLE TO BE FILLED SAME DAY ALL HOLE TO BE TAMPED AND SODDED						

MATCH SHEET 6

PROPOSED COMCAST NEW ATTACHMENT
 18' MINIMUM HEIGHT AT ALL POINTS
 1 24CT FIBER CABLE
 INSTALLATION LENGTH IN RW ON THIS SHEET 258 FT

NO MATCH SHEET

NO MATCH SHEET

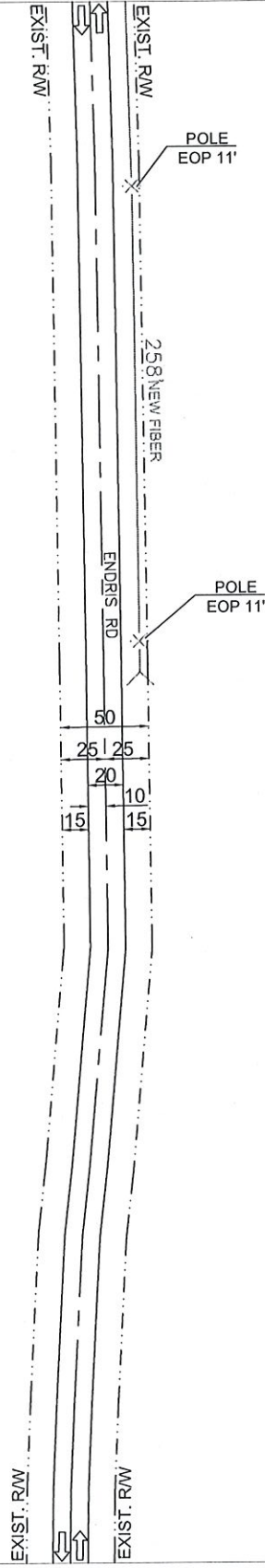

NO MATCH SHEET

PREPARED BY: 	[Symbol] EXISTING POLE [Symbol] PROPOSED PEDESTAL [Symbol] PROPOSED VAULT [Symbol] WATER VALVE [Symbol] FIBER MARKER [Symbol] GAS MARKER [Symbol] MANHOLE [Symbol] SEWER MANHOLE [Symbol] STORM DRAIN	[Symbol] RIGHT OF WAY LINE [Symbol] IRRIGATION LINE [Symbol] WATER LANE [Symbol] GAS LANE [Symbol] PROPOSED ANCHOR [Symbol] PROPOSED RISER (R) 25	[Symbol] PROPOSED COAXIAL CABLE [Symbol] PROPOSED FIBER CABLE [Symbol] PROPOSED DIRECTIONAL BORE [Symbol] EXISTING CABLE [Symbol] COUNTY LINE		ENGINEERED FOR: 	MADISON COUNTY ENDRIS RD TRANSPORT FIBER
	LEGEND: RW - RIGHT OF WAY EOP - EDGE OF PAVEMENT DW - DRIVEWAY PDW - PAVED DRIVEWAY				NOTES: BORE HOLE TO BE FILLED SAME DAY VAULT HOLE TO BE FILLED SAME DAY ALL HOLE TO BE TAMPED AND SOODED	NO SCALE SHEET 7 OF 26

NO MATCH SHEET

PROPOSED COMCAST UNDERGROUND
DIRECTIONAL BORE
4' MINIMUM DEPTH AT ALL POINTS
1 48CT FIBER CABLE
NO OTHER BURIED UTILITIES EXIST

INSTALLATION LENGTH IN RW ON THIS SHEET 670 FT

MATCH SHEET 4

MATCH SHEET 9

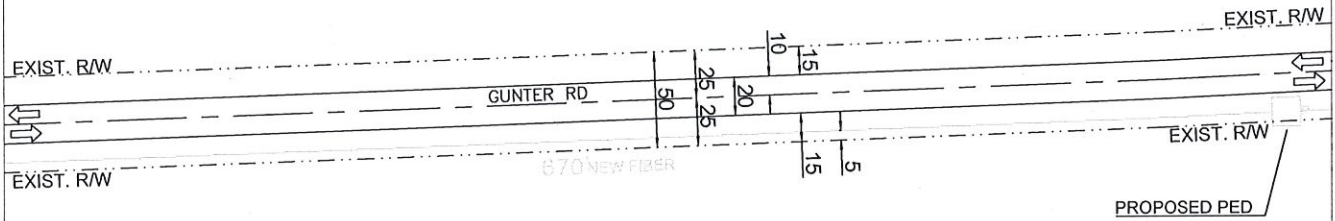

NO MATCH SHEET

PREPARED BY: 	EXISTING POLE PROPOSED PEDESTAL PROPOSED VAULT WATER VALVE FIBER MARKER GAS MARKER MANHOLE SEWER MANHOLE STORM DRAIN	RIGHT OF WAY LINE IRRIGATION LINE WATER LANE GAS LANE PROPOSED ANCHOR PROPOSED RISER LEGEND: RW - RIGHT OF WAY EOP - EDGE OF PAVEMENT DW - DRIVEWAY POW - PAVED DRIVEWAY	PROPOSED COAXIAL CABLE PROPOSED FIBER CABLE PROPOSED DIRECTIONAL BORE EXISTING CABLE COUNTY LINE		ENGINEERED FOR: 	MADISON COUNTY GUNTER ROAD TRANSPORT FIBER
	NOTES: BORE HOLE TO BE FILLED SAME DAY VAULT HOLE TO BE FILLED SAME DAY ALL HOLE TO BE TAMPED AND SODDED	NO SCALE SHEET 8 OF 26				

NO MATCH SHEET

PROPOSED COMCAST UNDERGROUND
 DIRECTIONAL BORE
 4' MINIMUM DEPTH AT ALL POINTS
 1 48CT FIBER CABLE
 NO OTHER BURIED UTILITIES EXIST

INSTALLATION LENGTH IN RW ON THIS SHEET 700 FT

MATCH SHEET 8

MATCH SHEET 10



NO MATCH SHEET

PREPARED BY: 	EXISTING POLE PROPOSED PEDESTAL PROPOSED VAULT WATER VALVE FIBER MARKER GAS MARKER MANHOLE SEWER MANHOLE STORM DRAIN	RIGHT OF WAY LINE IRRIGATION LINE WATER LANE GAS LANE PROPOSED ANCHOR PROPOSED RISER	PROPOSED COAXIAL CABLE PROPOSED FIBER CABLE PROPOSED DIRECTIONAL BORE EXISTING CABLE COUNTY LINE		ENGINEERED FOR: MADISON COUNTY GUNTER ROAD TRANSPORT FIBER		NO SCALE	SHEET 9 OF 26
	LEGEND: RW - RIGHT OF WAY EOP - EDGE OF PAVEMENT DW - DRIVEWAY PDW - PAVED DRIVEWAY	NOTES: BORE HOLE TO BE FILLED SAME DAY VAULT HOLE TO BE FILLED SAME DAY ALL HOLE TO BE TAMPED AND SOODED						

NO MATCH SHEET

PROPOSED COMCAST UNDERGROUND
 DIRECTIONAL BORE
 4' MINIMUM DEPTH AT ALL POINTS
 1 48CT FIBER CABLE
 NO OTHER BURIED UTILITIES EXIST

INSTALLATION LENGHT IN RW ON THIS SHEET 694 FT

MATCH SHEET 9

MATCH SHEET 11

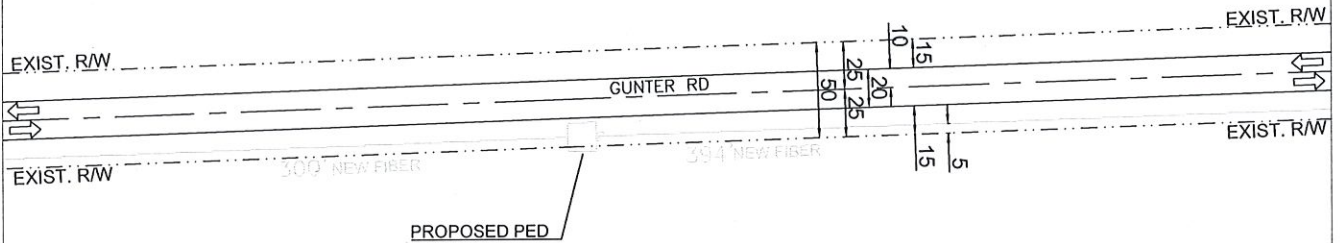

NO MATCH SHEET

PREPARED BY: 	EXISTING POLE PROPOSED PEDESTAL PROPOSED VAULT WATER VALVE FIBER MARKER GAS MARKER MAN-HOLE SEWER MANHOLE STORM DRAIN	RIGHT OF WAY LINE IRRIGATION LINE WATER LANE GAS LANE PROPOSED ANCHOR PROPOSED RISER (R) 25	PROPOSED COAXIAL CABLE PROPOSED FIBER CABLE PROPOSED DIRECTIONAL BORE EXISTING CABLE COUNTY LINE		ENGINEERED FOR: 	MADISON COUNTY GUNTER ROAD TRANSPORT FIBER
	LEGEND: RW - RIGHT OF WAY FOP - EDGE OF PAVEMENT DW - DRIVEWAY PDW - PAVED DRIVEWAY	NOTES: BORE HOLE TO BE FILLED SAME DAY VAULT HOLE TO BE FILLED SAME DAY ALL HOLE TO BE TAMPED AND SODDED	NO SCALE SHEET 10 OF 26			

NO MATCH SHEET

PROPOSED COMCAST UNDERGROUND
 DIRECTIONAL BORE
 4' MINIMUM DEPTH AT ALL POINTS
 1 48CT FIBER CABLE
 NO OTHER BURIED UTILITIES EXIST

INSTALLATION LENGTH IN RW ON THIS SHEET 780 FT

MATCH SHEET 10

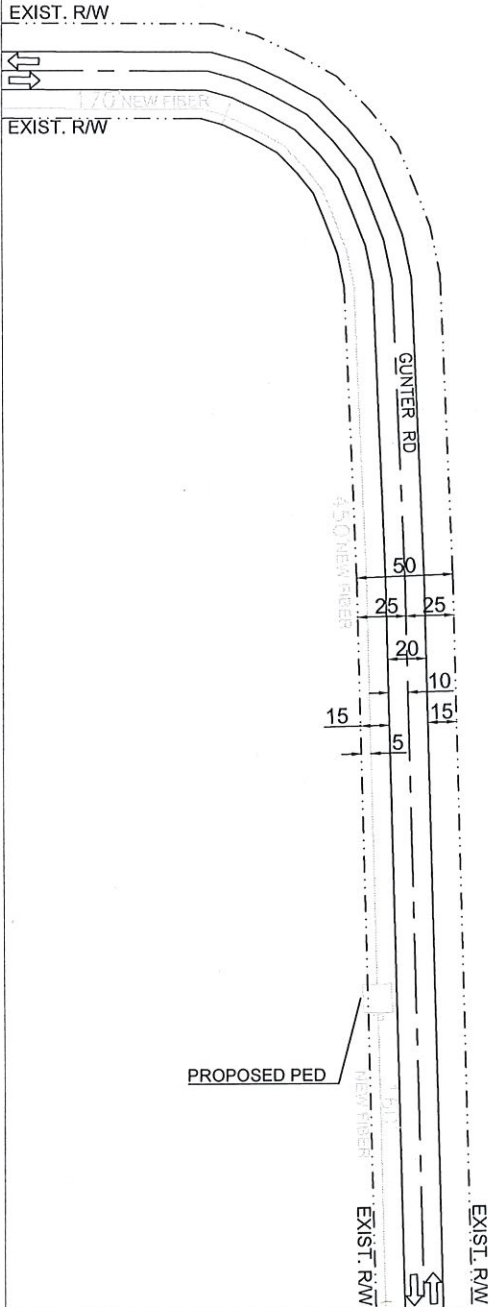

NO MATCH SHEET

MATCH SHEET 12

PREPARED BY: 	EXISTING POLE PROPOSED PEDESTAL PROPOSED VAULT WATER VALVE FIBER MARKER GAS MARKER MANHOLE SEWER MANHOLE STORM DRAIN	RIGHT OF WAY LINE IRRIGATION LINE WATER LANE GAS LANE PROPOSED ANCHOR PROPOSED RISER	PROPOSED COAXIAL CABLE PROPOSED FIBER CABLE PROPOSED DIRECTIONAL BORE EXISTING CABLE COUNTY LINE		ENGINEERED FOR: 	MADISON COUNTY GUNTER ROAD TRANSPORT FIBER
	LEGEND: RW - RIGHT OF WAY EOP - EDGE OF PAVEMENT DW - DRIVEWAY PDW - PAVED DRIVEWAY	NOTES: BORE HOLE TO BE FILLED SAME DAY VAULT HOLE TO BE FILLED SAME DAY ALL HOLE TO BE TAMPED AND SOODED	NO SCALE		SHEET 11 OF 26	

MATCH SHEET 11

PROPOSED COMCAST UNDERGROUND
DIRECTIONAL BORE
4' MINIMUM DEPTH AT ALL POINTS
1 48CT FIBER CABLE
NO OTHER BURIED UTILITIES EXIST

INSTALLATION LENGTH IN RW ON THIS SHEET 1131 FT

NO MATCH SHEET

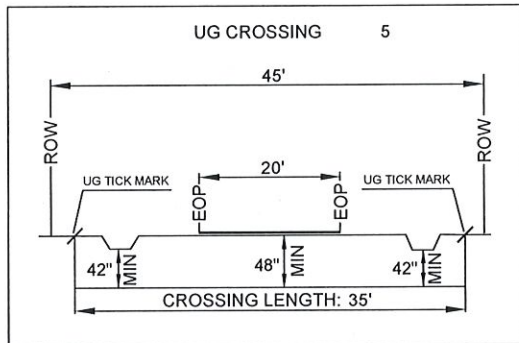
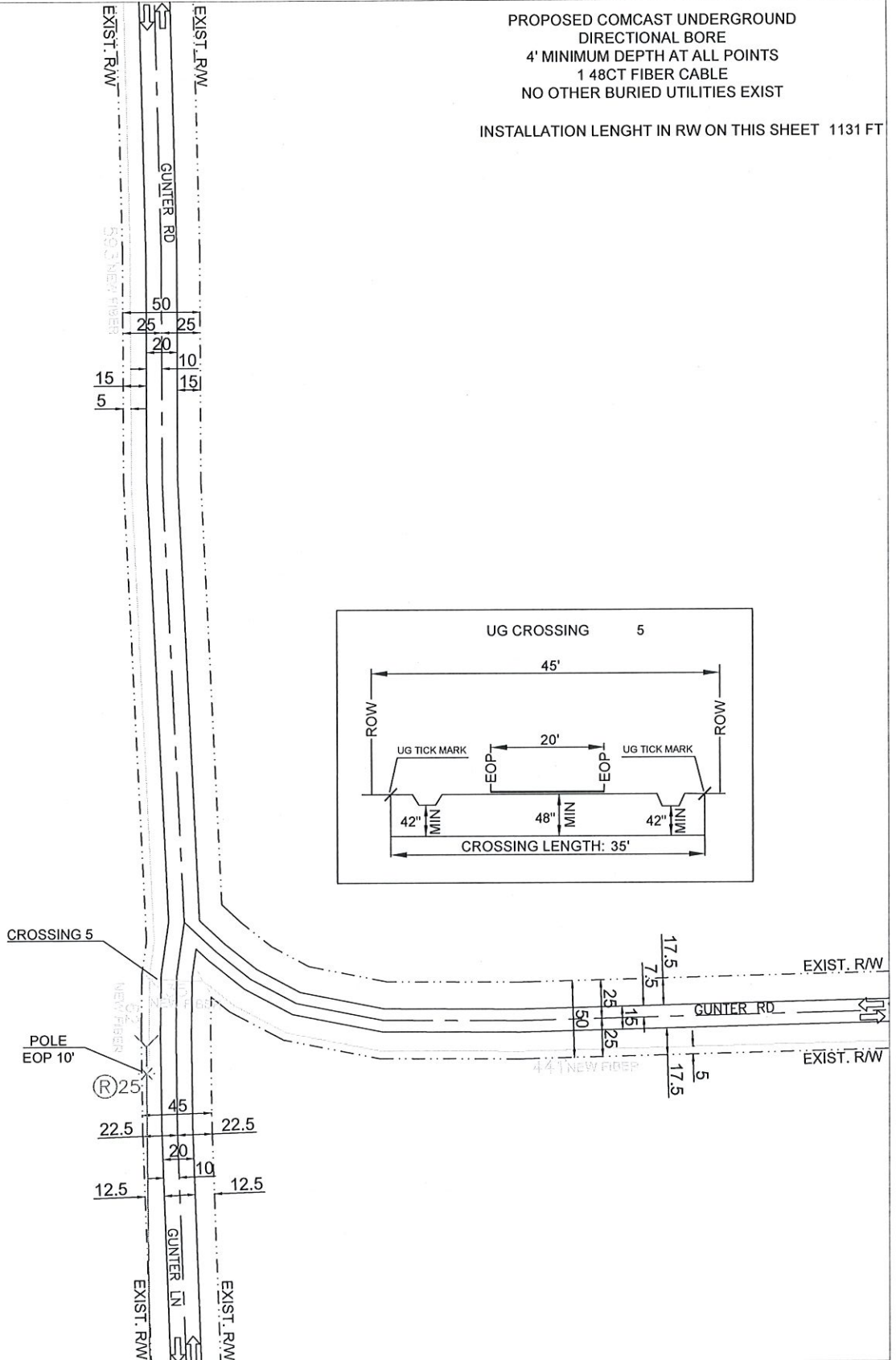

MATCH SHEET 16

MATCH SHEET 13

PREPARED BY: 	EXISTING POLE PROPOSED PEDESTAL PROPOSED VAULT WATER VALVE FIBER MARKER GAS MARKER MANHOLE SEWER MANHOLE STORM DRAIN	RIGHT OF WAY LINE IRRIGATION LINE WATER LANE GAS LANE PROPOSED ANCHOR PROPOSED RISER	PROPOSED COAXIAL CABLE PROPOSED FIBER CABLE PROPOSED DIRECTIONAL BORE EXISTING CABLE COUNTY LINE		ENGINEERED FOR: MADISON COUNTY GUNTER ROAD GUNTER LN TRANSPORT FIBER		NO SCALE SHEET 12 OF 26
		LEGEND: RW - RIGHT OF WAY EOP - EDGE OF PAVEMENT DW - DRIVEWAY PDW - PAVED DRIVEWAY	NOTES: BORE HOLE TO BE FILLED SAME DAY VAULT HOLE TO BE FILLED SAME DAY ALL HOLE TO BE TAMPED AND SODDED				

MATCH SHEET 12

PROPOSED COMCAST NEW ATTACHMENT
 18' MINIMUM HEIGHT AT ALL POINTS
 1 24CT FIBER CABLE
 1 48CT FIBER CABLE
 INSTALLATION LENGTH IN RW ON THIS SHEET 484 FT

NO MATCH SHEET

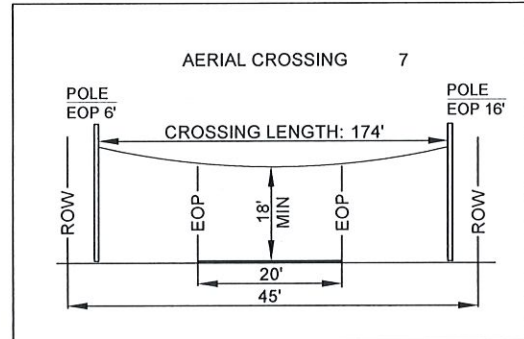
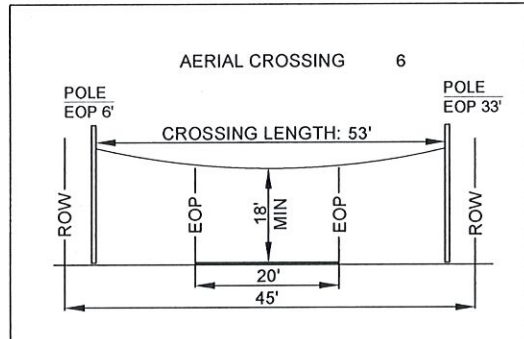
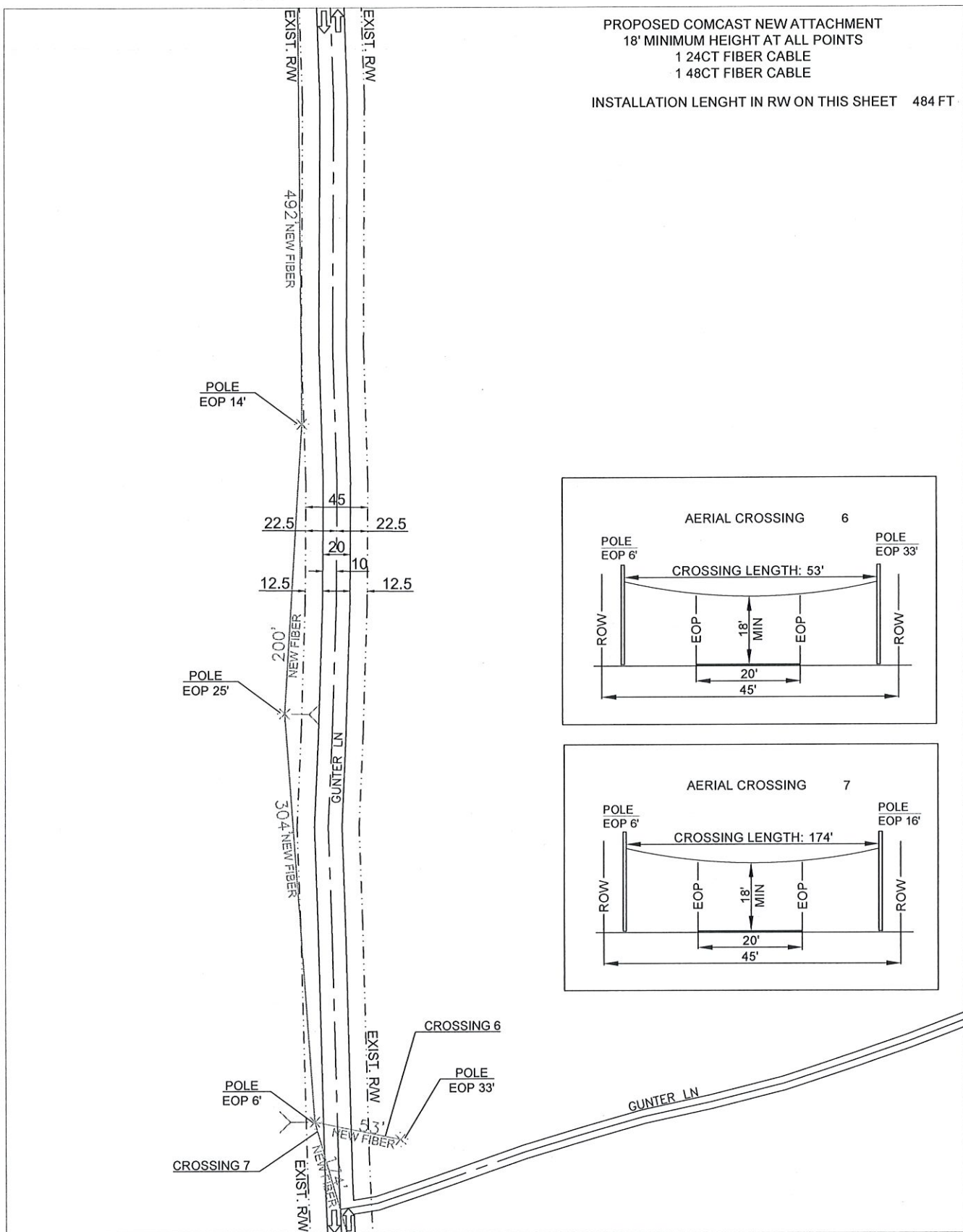

MATCH SHEET 15

MATCH SHEET 14

PREPARED BY: 	EXISTING POLE PROPOSED PEDESTAL PROPOSED VAULT WATER VALVE FIBER MARKER GAS MARKER MANHOLE SEWER MAIN/HOLE STORM DRAIN	RIGHT OF WAY LINE IRRIGATION LINE WATER LAINE GAS LAINE PROPOSED ANCHOR PROPOSED RISER	PROPOSED COAXIAL CABLE PROPOSED FIBER CABLE PROPOSED DIRECTIONAL BORE EXISTING CABLE COUNTY LINE		ENGINEERED FOR: MADISON COUNTY GUNTER LN TRANSPORT FIBER		NO SCALE	SHEET 13 OF 28
	LEGEND: RW - RIGHT OF WAY EOP - EDGE OF PAVEMENT DW - DRIVEWAY PDW - PAVED DRIVEWAY	NOTES: BORE HOLE TO BE FILLED SAME DAY VAULT HOLE TO BE FILLED SAME DAY ALL HOLE TO BE TAMPED AND SODDED	COMCAST					

MATCH SHEET 13

PROPOSED COMCAST NEW ATTACHMENT
 18' MINIMUM HEIGHT AT ALL POINTS
 1 24CT FIBER CABLE

INSTALLATION LENGTH IN RW ON THIS SHEET 944 FT

NO MATCH SHEET

NO MATCH SHEET

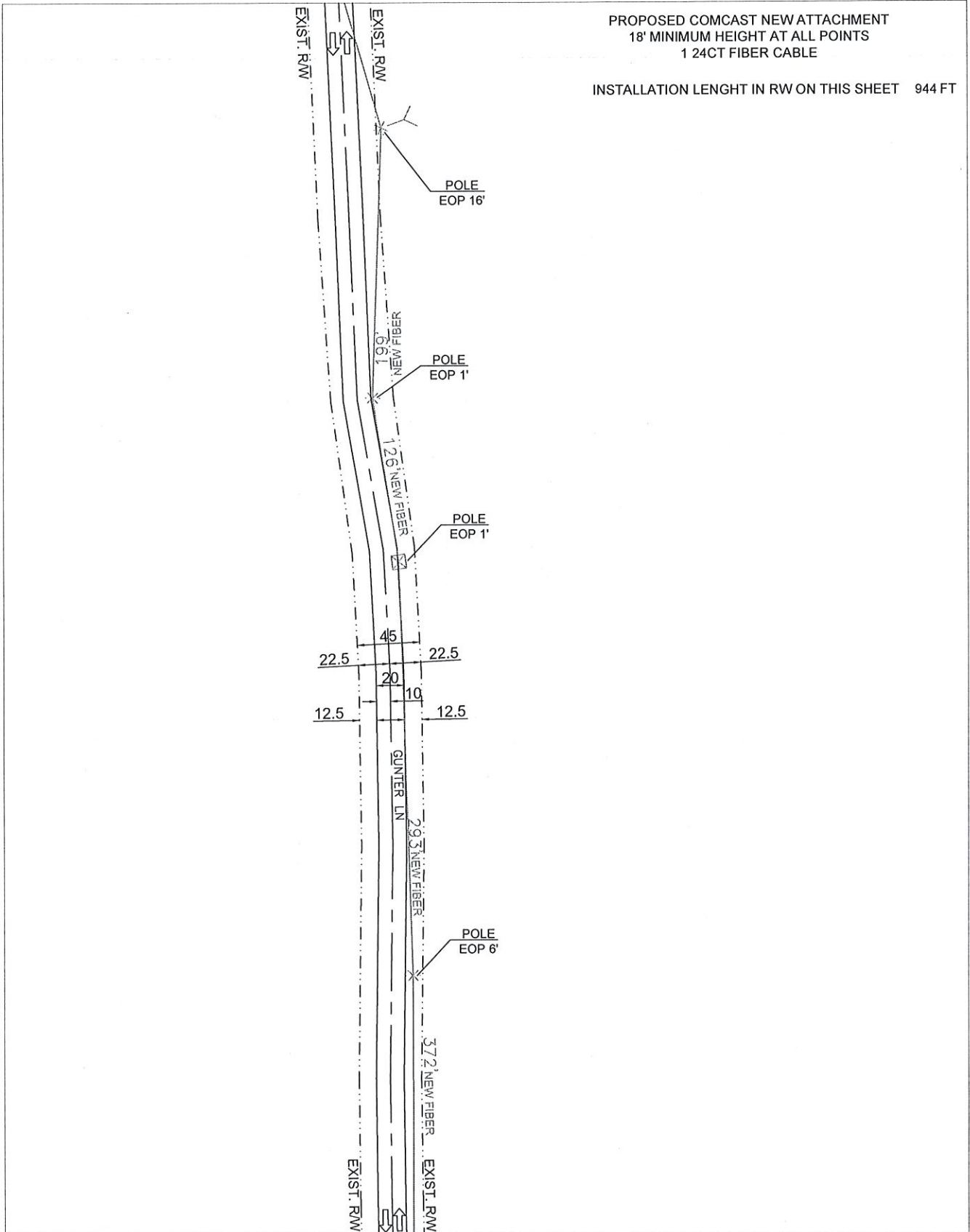

MATCH SHEET 15

PREPARED BY: 	EXISTING POLE PROPOSED PEDESTAL PROPOSED VAULT WATER VALVE FIBER MARKER GAS MARKER MANHOLE SEWER MANHOLE STORM DRAIN	RIGHT OF WAY LINE IRRIGATION LINE WATER LANE GAS LANE PROPOSED ANCHOR PROPOSED RISER	PROPOSED COAXIAL CABLE PROPOSED FIBER CABLE PROPOSED DIRECTIONAL BORE EXISTING CABLE COUNTY LINE		ENGINEERED FOR: 	MADISON COUNTY GUNTER LN TRANSPORT FIBER
	LEGEND: RW - RIGHT OF WAY EOP - EDGE OF PAVEMENT DW - DRIVEWAY POW - PAVED DRIVEWAY	NOTES: BORE HOLE TO BE FILLED SAME DAY VAULT HOLE TO BE FILLED SAME DAY ALL HOLE TO BE TAMPED AND SODDED	NO SCALE SHEET 14 OF 28			

MATCH SHEET 14

PROPOSED COMCAST NEW ATTACHMENT
 18' MINIMUM HEIGHT AT ALL POINTS
 1 24CT FIBER CABLE
 INSTALLATION LENGTH IN RW ON THIS SHEET 276 FT

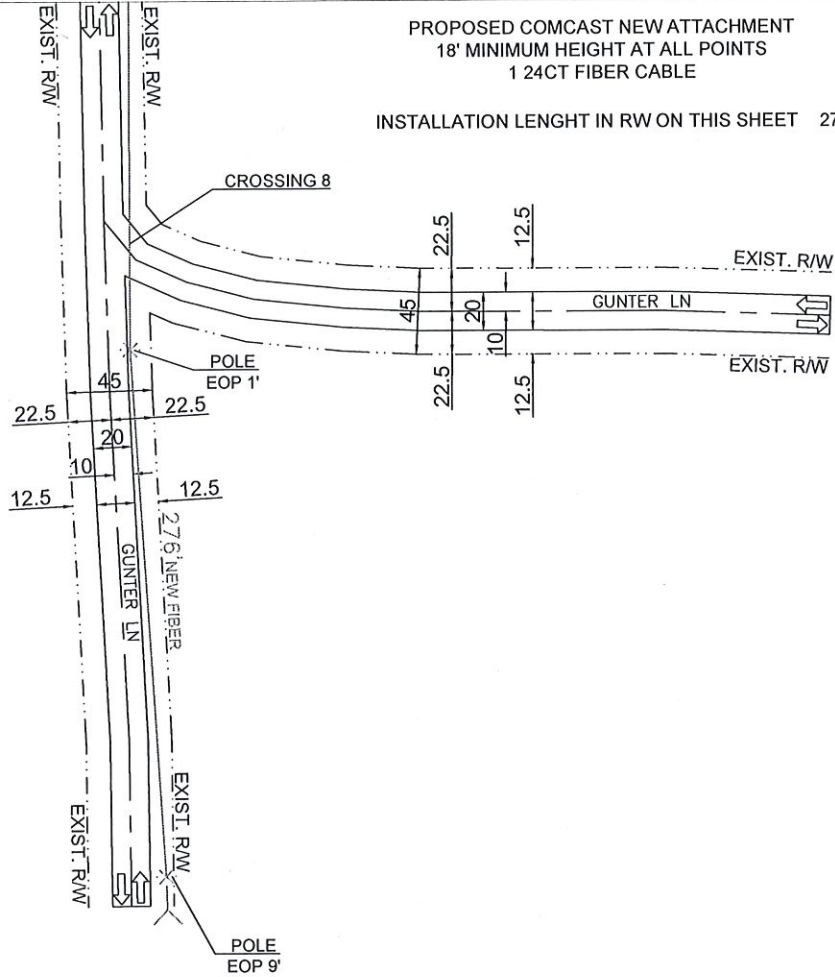

NO MATCH SHEET

NO MATCH SHEET

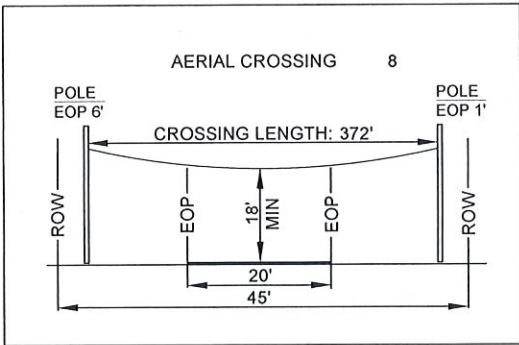

NO MATCH SHEET

PREPARED BY: 	EXISTING POLE PROPOSED PEDESTAL PROPOSED VAULT WATER VALVE FIBER MARKER GAS MARKER MANHOLE SEWER MANHOLE STORM DRAIN	RIGHT OF WAY LINE IRRIGATION LINE WATER LANE GAS LANE PROPOSED ANCHOR PROPOSED RISER	PROPOSED COAXIAL CABLE PROPOSED FIBER CABLE PROPOSED DIRECTIONAL BORE EXISTING CABLE COUNTY LINE		ENGINEERED FOR: 	MADISON COUNTY GUNTER LN TRANSPORT FIBER
	LEGEND: RW - RIGHT OF WAY EOP - EDGE OF PAVEMENT DW - DRIVEWAY PDW - PAVED DRIVEWAY	NOTES: BORE HOLE TO BE FILLED SAME DAY VAULT HOLE TO BE FILLED SAME DAY ALL HOLE TO BE TAMPED AND SODDED	NO SCALE SHEET 15 OF 26			

NO MATCH SHEET

PROPOSED COMCAST UNDERGROUND
DIRECTIONAL BORE
4' MINIMUM DEPTH AT ALL POINTS
1 48CT FIBER CABLE
NO OTHER BURIED UTILITIES EXIST

INSTALLATION LENGTH IN RW ON THIS SHEET 1007 FT

MATCH SHEET 12

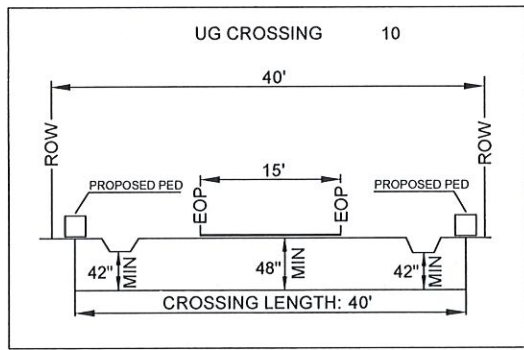
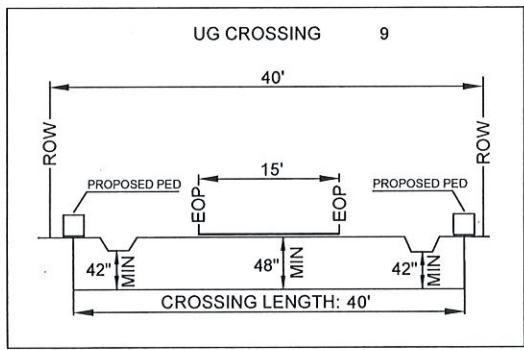
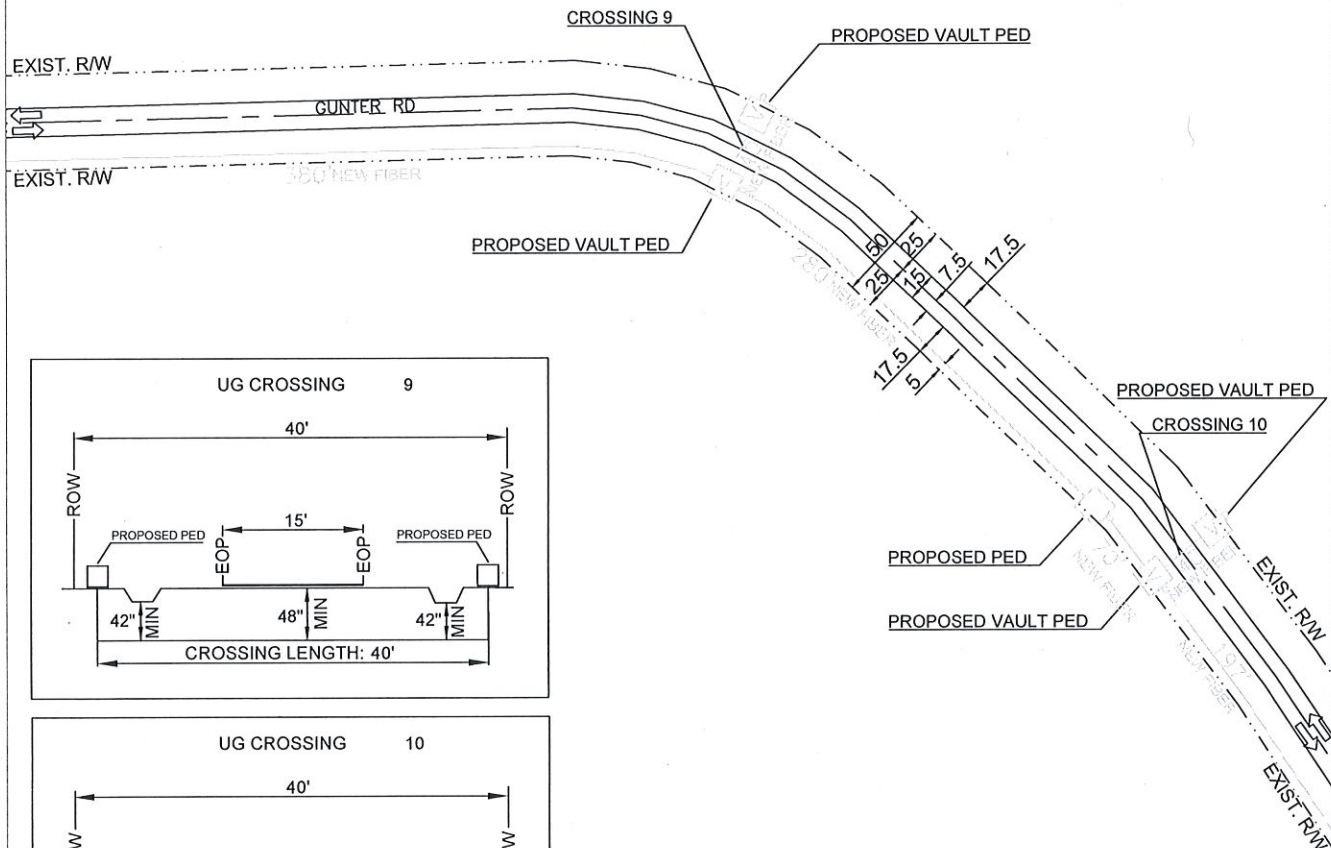

MATCH SHEET 17

NO MATCH SHEET

PREPARED BY: 	EXISTING POLE PROPOSED PEDESTAL PROPOSED VAULT WATER VALVE FIBER MARKER GAS MARKER MANHOLE SEWER MANHOLE STORM DRAIN	RIGHT OF WAY LINE IRRIGATION LINE WATER LANE GAS LANE PROPOSED ANCHOR PROPOSED RISER	PROPOSED COAXIAL CABLE PROPOSED FIBER CABLE PROPOSED DIRECTIONAL BORE EXISTING CABLE COUNTY LINE		ENGINEERED FOR: 	MADISON COUNTY GUNTER ROAD TRANSPORT FIBER
	LEGEND: RW - RIGHT OF WAY EOP - EDGE OF PAVEMENT DW - DRIVEWAY PDW - PAVED DRIVEWAY	NOTES: BORE HOLE TO BE FILLED SAME DAY VAULT HOLE TO BE FILLED SAME DAY ALL HOLE TO BE TAMPED AND SOCCDED	NO SCALE		SHEET 16 OF 28	

NO MATCH SHEET

PROPOSED COMCAST UNDERGROUND
DIRECTIONAL BORE
4' MINIMUM DEPTH AT ALL POINTS
1 48CT FIBER CABLE
NO OTHER BURIED UTILITIES EXIST

INSTALLATION LENGTH IN RW ON THIS SHEET 842 FT

MATCH SHEET 16

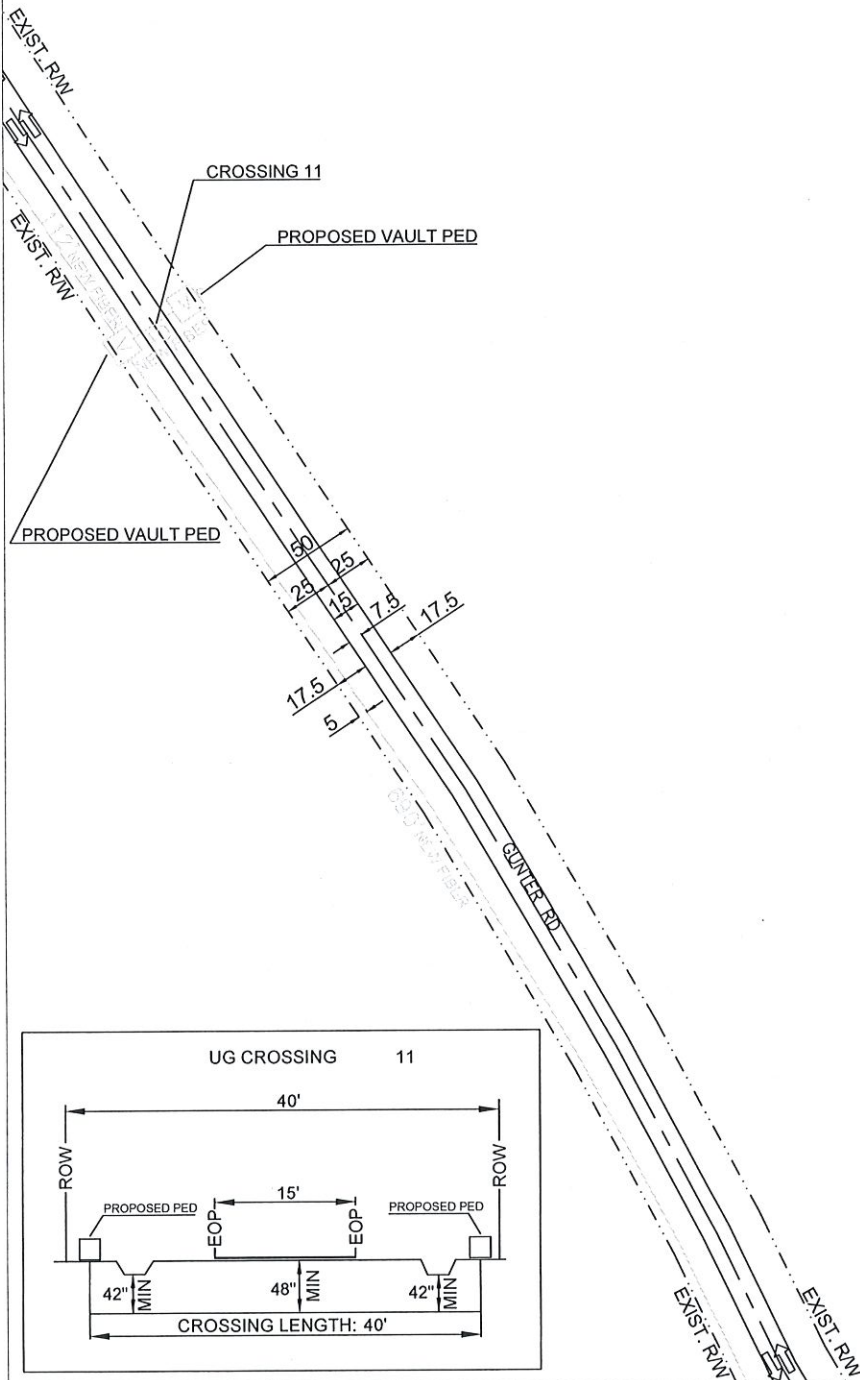

NO MATCH SHEET

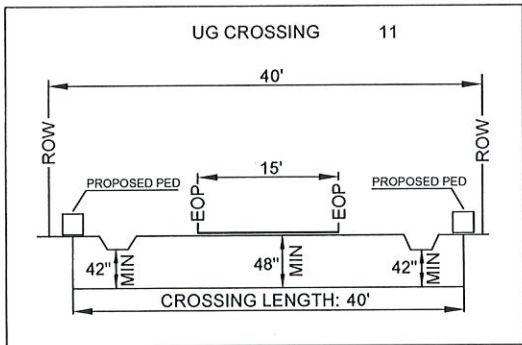

MATCH SHEET 18

PREPARED BY: 	EXISTING POLE PROPOSED PEDESTAL PROPOSED VAULT WATER VALVE FIBER MARKER GAS MARKER MANHOLE SEWER MANHOLE STORM DRAIN	RIGHT OF WAY LINE IRRIGATION LINE WATER LANE GAS LANE PROPOSED ANCHOR PROPOSED RISER LEGEND: RW - RIGHT OF WAY EOP - EDGE OF PAVEMENT DW - DRIVEWAY ROW - PAVED DRIVEWAY	PROPOSED COAXIAL CABLE PROPOSED FIBER CABLE PROPOSED DIRECTIONAL BORE EXISTING CABLE COUNTY LINE		ENGINEERED FOR: 	MADISON COUNTY GUNTER ROAD TRANSPORT FIBER
	NOTES: BORE HOLE TO BE FILLED SAME DAY VAULT HOLE TO BE FILLED SAME DAY ALL HOLE TO BE TAMPED AND SODDED	NO SCALE	SHEET 17 OF 26			

MATCH SHEET 17

PROPOSED COMCAST UNDERGROUND
 DIRECTIONAL BORE
 4' MINIMUM DEPTH AT ALL POINTS
 1 48CT FIBER CABLE
 NO OTHER BURIED UTILITIES EXIST

INSTALLATION LENGHT IN RW ON THIS SHEET 1010 FT

NO MATCH SHEET

NO MATCH SHEET

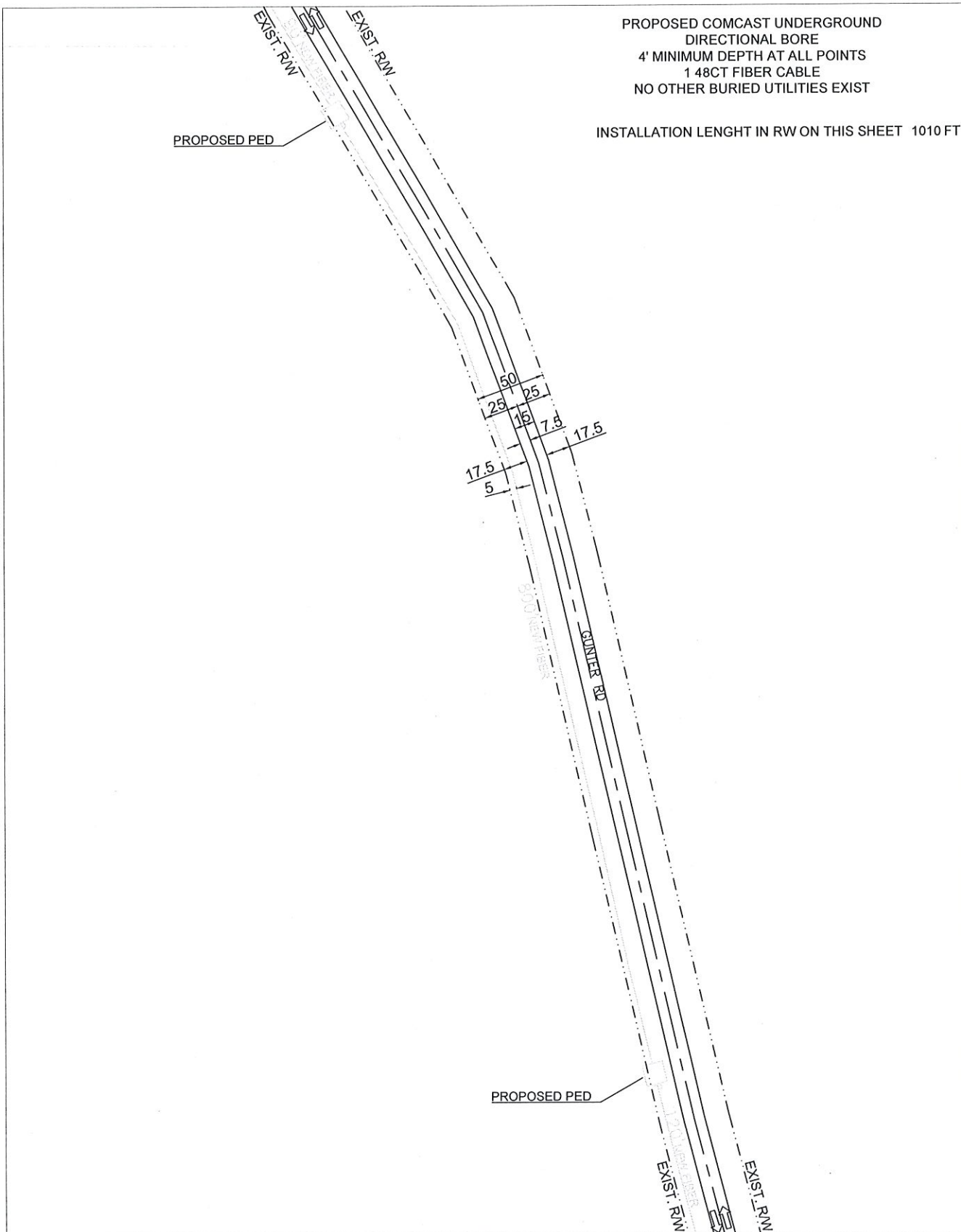

MATCH SHEET 19

PREPARED BY: 	EXISTING POLE PROPOSED PEDESTAL PROPOSED VAULT WATER VALVE FIBER MARKER GAS MARKER MANHOLE SEWER MAIN/HOLE STORM DRAIN	RIGHT OF WAY LINE IRRIGATION LINE WATER LAINE GAS LAINE PROPOSED ANCHOR PROPOSED RISER	PROPOSED COAXIAL CABLE PROPOSED FIBER CABLE PROPOSED DIRECTIONAL BORE EXISTING CABLE COUNTY LINE		ENGINEERED FOR: MADISON COUNTY GUNTER ROAD TRANSPORT FIBER		NO SCALE SHEET 18 OF 28
	LEGEND: RW - RIGHT OF WAY EOP - EDGE OF PAVEMENT DW - DRIVEWAY PDM - PAVED DRIVEWAY	NOTES: BORE HOLE TO BE FILLED SAME DAY VAULT HOLE TO BE FILLED SAME DAY ALL HOLE TO BE TAMPED AND SODDED					

PROPOSED COMCAST UNDERGROUND
 DIRECTIONAL BORE
 4' MINIMUM DEPTH AT ALL POINTS
 1 48CT FIBER CABLE
 NO OTHER BURIED UTILITIES EXIST

INSTALLATION LENGTH IN RW ON THIS SHEET 778 FT

NO MATCH SHEET

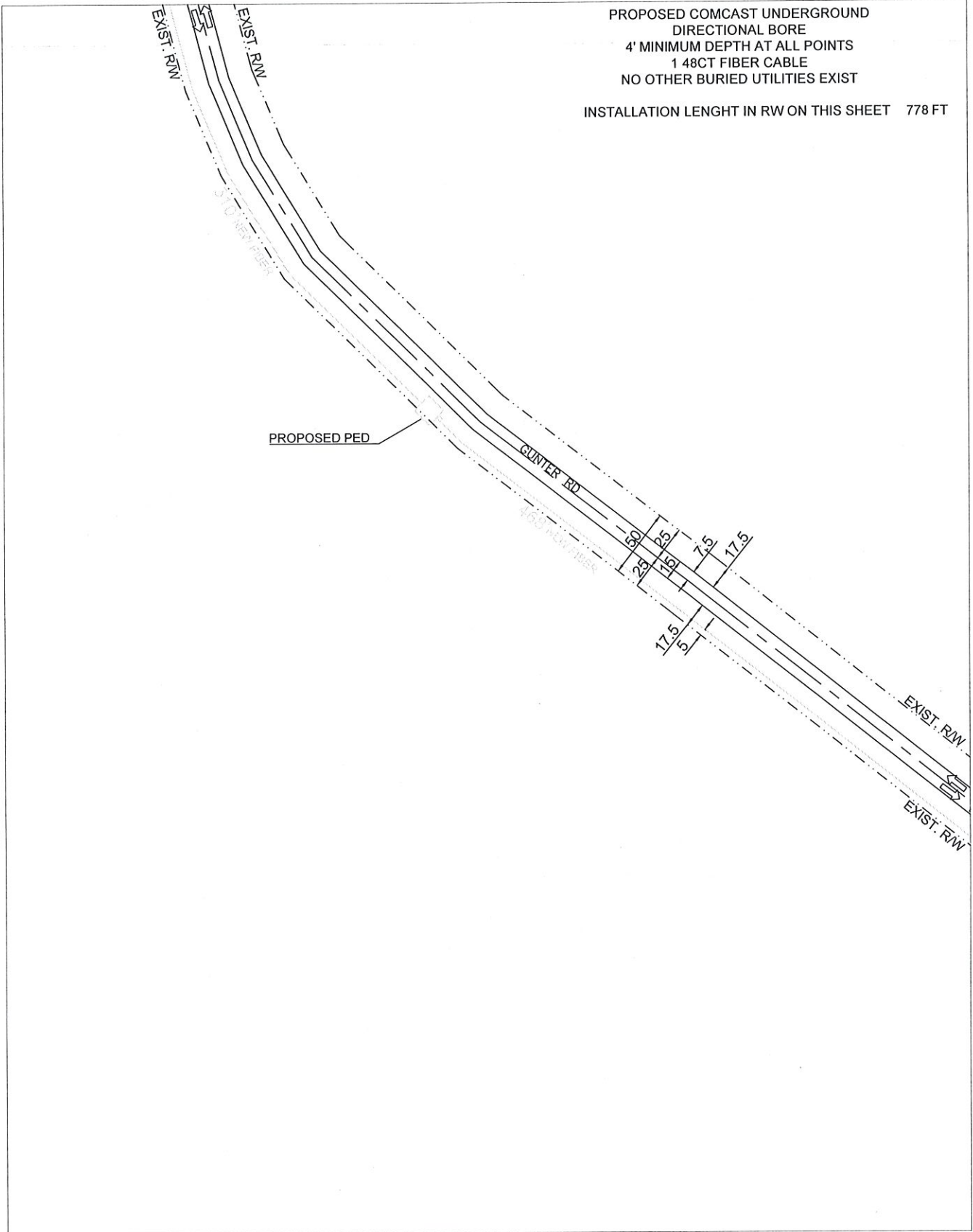

MATCH SHEET 20

NO MATCH SHEET

PREPARED BY: 	EXISTING POLE PROPOSED PEDESTAL PROPOSED VAULT WATER VALVE FIBER MARKER GAS MARKER MANHOLE SEWER MANHOLE STORM DRAIN	RIGHT OF WAY LINE IRRIGATION LINE WATER LAINE GAS LAINE PROPOSED ANCHOR PROPOSED RISER LEGEND: RW - RIGHT OF WAY EOP - EDGE OF PAVEMENT DW - DRIVEWAY PDW - PAVED DRIVEWAY	PROPOSED COAXIAL CABLE PROPOSED FIBER CABLE PROPOSED DIRECTIONAL BORE EXISTING CABLE COUNTY LINE		ENGINEERED FOR: 	MADISON COUNTY GUNTER ROAD TRANSPORT FIBER
	NOTES: BORE HOLE TO BE FILLED SAME DAY VAULT HOLE TO BE FILLED SAME DAY ALL HOLE TO BE TAMPED AND SODDED	NO SCALE SHEET 19 OF 26				

MATCH SHEET 21

PROPOSED COMCAST UNDERGROUND
DIRECTIONAL BORE
4' MINIMUM DEPTH AT ALL POINTS
1 24CT FIBER CABLE
1 48CT FIBER CABLE
NO OTHER BURIED UTILITIES EXIST

INSTALLATION LENGTH IN RW ON THIS SHEET 1336 FT

MATCH SHEET 19

NO MATCH SHEET

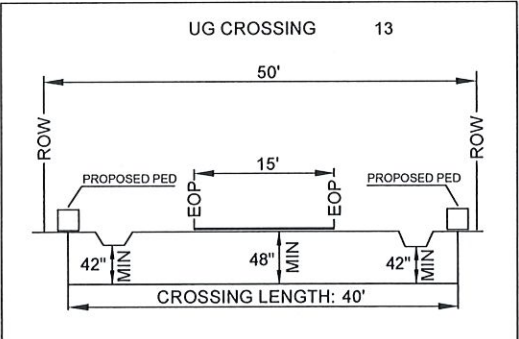
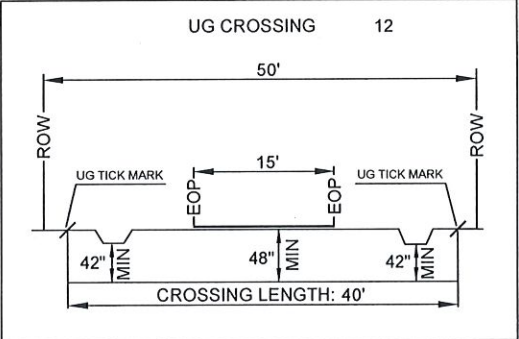
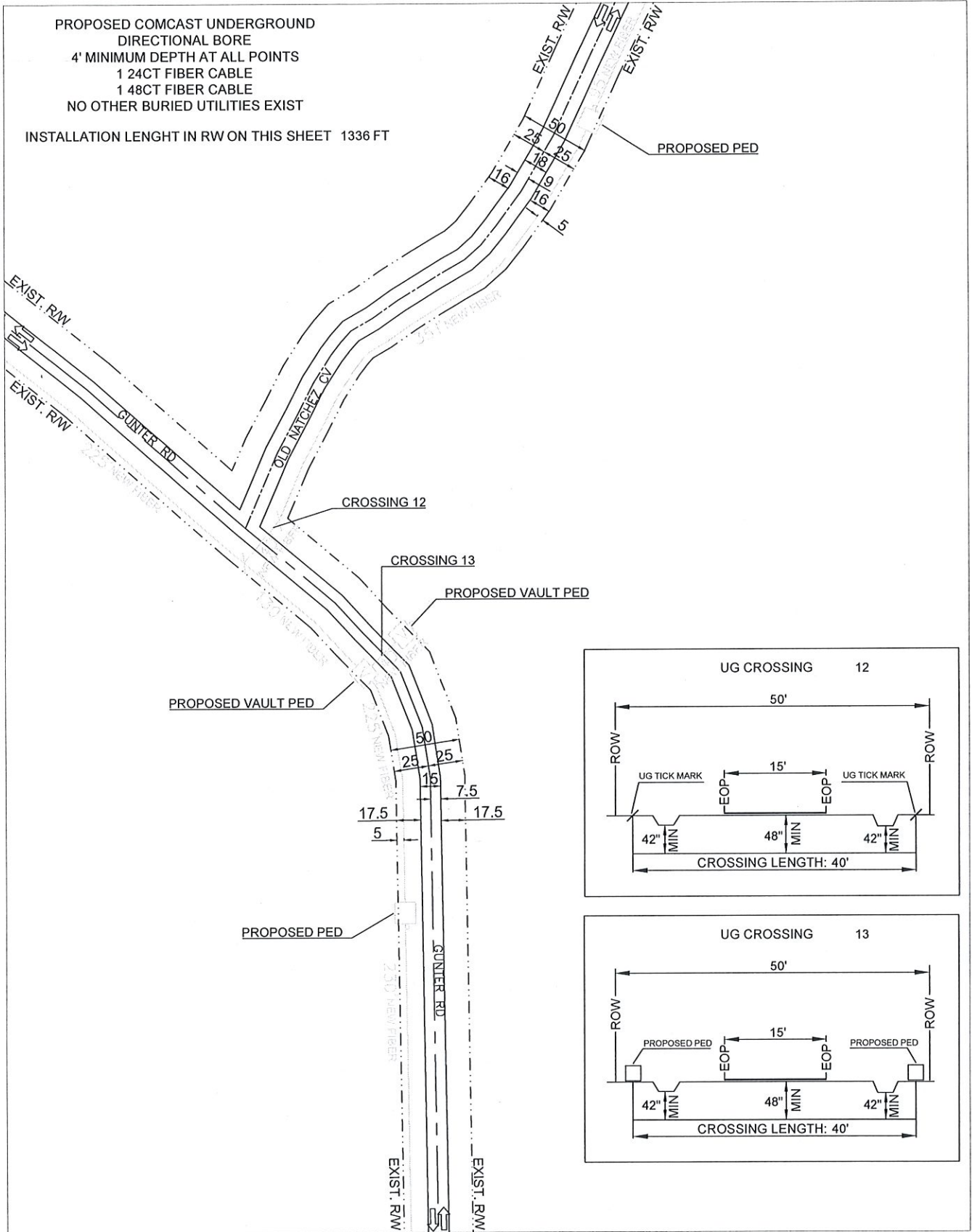

MATCH SHEET 23

PREPARED BY: 	EXISTING POLE PROPOSED PEDESTAL PROPOSED VAULT WATER VALVE FIBER MARKER GAS MARKER MANHOLE SEWER MANHOLE STORM DRAIN	RIGHT OF WAY LINE IRRIGATION LINE WATER LANE GAS LANE PROPOSED ANCHOR PROPOSED RISER	PROPOSED COAXIAL CABLE PROPOSED FIBER CABLE PROPOSED DIRECTIONAL BORE EXISTING CABLE COUNTY LINE		ENGINEERED FOR: 	MADISON COUNTY GUNTER ROAD OLD NATCHEZ CV TRANSPORT FIBER
	LEGEND: RW - RIGHT OF WAY EOP - EDGE OF PAVEMENT DW - DRIVEWAY PDW - PAVED DRIVEWAY	NOTES: BORE HOLE TO BE FILLED SAME DAY VAULT HOLE TO BE FILLED SAME DAY ALL HOLE TO BE TAMPED AND SODDED	NO SCALE		SHEET 20 OF 26	

MATCH SHEET 22

PROPOSED COMCAST UNDERGROUND
 DIRECTIONAL BORE
 4' MINIMUM DEPTH AT ALL POINTS
 1 24CT FIBER CABLE
 NO OTHER BURIED UTILITIES EXIST

INSTALLATION LENGTH IN RW ON THIS SHEET 955 FT

NO MATCH SHEET

NO MATCH SHEET

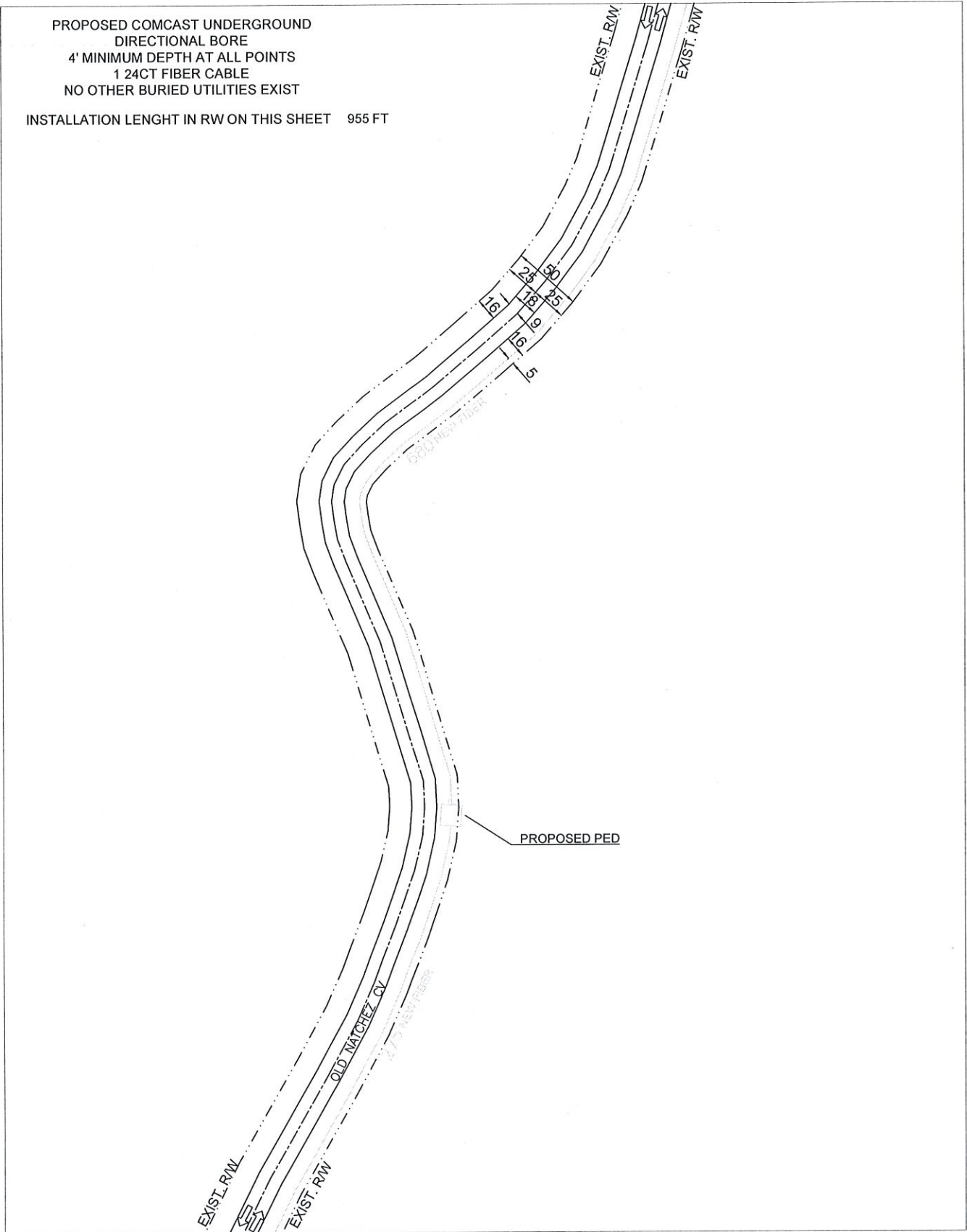

MATCH SHEET 20

PREPARED BY: 	EXISTING POLE PROPOSED PEDESTAL PROPOSED VAULT WATER VALVE FIBER MARKER GAS MARKER MANHOLE SEWER MANHOLE STORM DRAIN	RIGHT OF WAY LINE IRRIGATION LINE WATER LAINE GAS LAINE PROPOSED ANCHOR PROPOSED RISER LEGEND: RW - RIGHT OF WAY EOP - EDGE OF PAVEMENT DW - DRIVEWAY PDW - PAVED DRIVEWAY	PROPOSED COAXIAL CABLE PROPOSED FIBER CABLE PROPOSED DIRECTIONAL BORE EXISTING CABLE COUNTY LINE		ENGINEERED FOR: 	MADISON COUNTY OLD NATCHEZ CV TRANSPORT FIBER
	NOTES: BORE HOLE TO BE FILLED SAME DAY VAULT HOLE TO BE FILLED SAME DAY ALL HOLE TO BE TAMPED AND SODDED	NO SCALE SHEET 21 OF 28				

NO MATCH SHEET

PROPOSED COMCAST UNDERGROUND
 DIRECTIONAL BORE
 4' MINIMUM DEPTH AT ALL POINTS
 1 24CT FIBER CABLE
 NO OTHER BURIED UTILITIES EXIST

INSTALLATION LENGTH IN RW ON THIS SHEET 720 FT

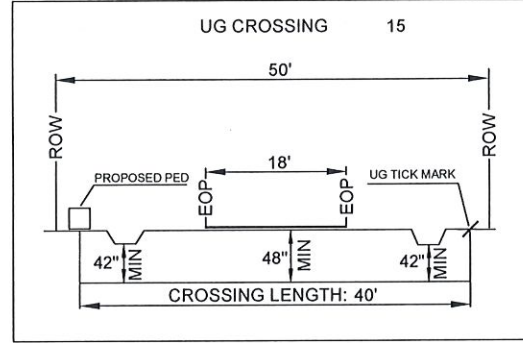
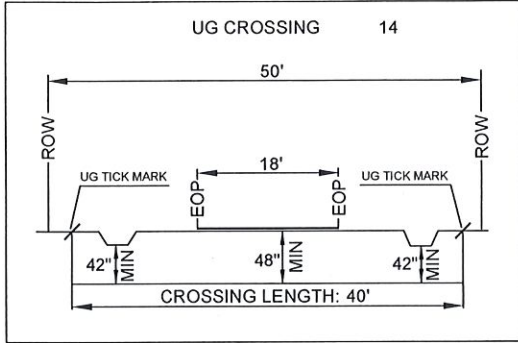

NO MATCH SHEET

NO MATCH SHEET

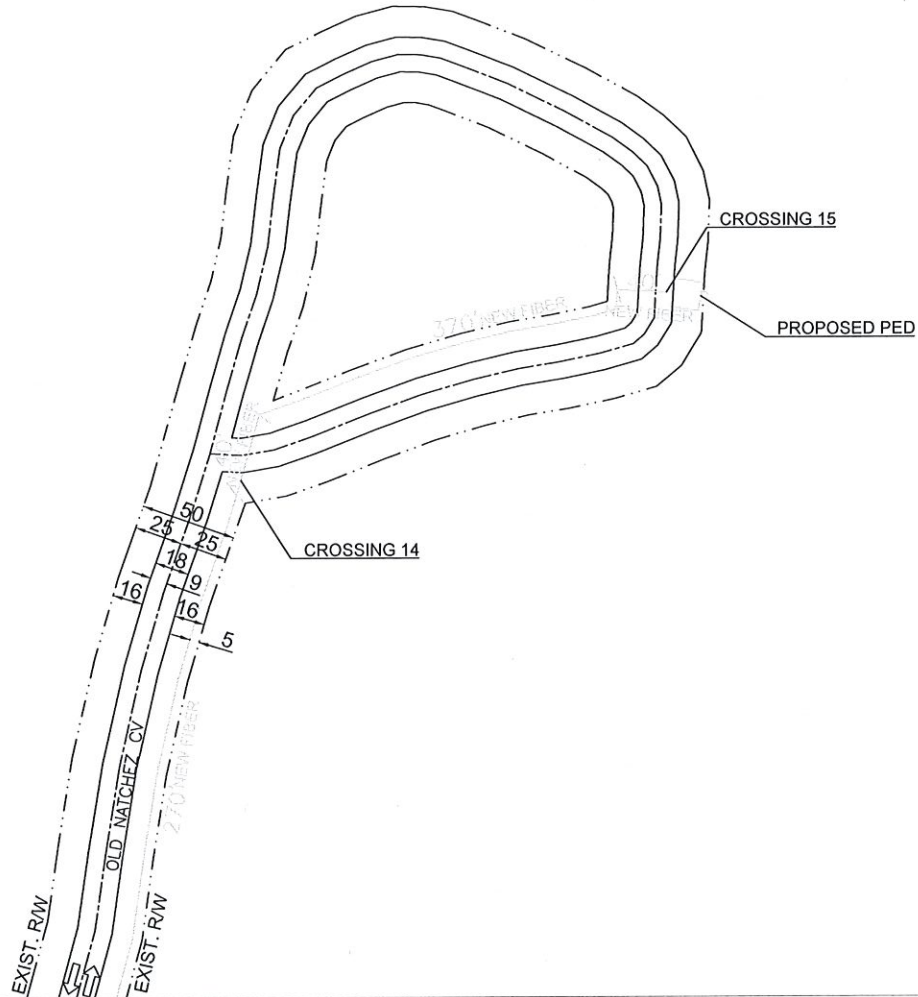

MATCH SHEET 21

PREPARED BY: 	EXISTING POLE PROPOSED PEDESTAL PROPOSED VAULT WATER VALVE FIBER MARKER GAS MARKER MANHOLE SEWER MANHOLE STORM DRAIN	RIGHT OF WAY LINE IRRIGATION LINE WATER LANE GAS LANE PROPOSED ANCHOR PROPOSED RISER	PROPOSED COAXIAL CABLE PROPOSED FIBER CABLE PROPOSED DIRECTIONAL BORE EXISTING CABLE COUNTY LINE		ENGINEERED FOR: 	MADISON COUNTY OLD NATCHEZ CV TRANSPORT FIBER
	LEGEND: RW - RIGHT OF WAY EOP - EDGE OF PAVEMENT DW - DRIVEWAY PDW - PAVED DRIVEWAY	NOTES: BORE HOLE TO BE FILLED SAME DAY VAULT HOLE TO BE FILLED SAME DAY ALL HOLE TO BE TAMPED AND SODDED	NO SCALE SHEET 22 OF 26			

MATCH SHEET 20

PROPOSED COMCAST UNDERGROUND
 DIRECTIONAL BORE
 4' MINIMUM DEPTH AT ALL POINTS
 1 24CT FIBER CABLE
 NO OTHER BURIED UTILITIES EXIST
 INSTALLATION LENGTH IN RW ON THIS SHEET 770 FT

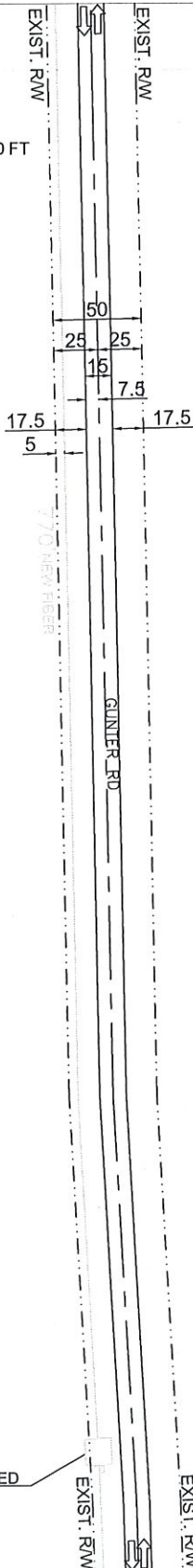

NO MATCH SHEET

NO MATCH SHEET

MATCH SHEET 24

PREPARED BY: 	<table border="0"> <tr> <td> <ul style="list-style-type: none"> ⊗ EXISTING POLE □ PROPOSED PEDESTAL ▣ PROPOSED VAULT ⊕ WATER VALVE ⊙ FIBER MARKER ⊙ GAS MARKER ⊙ MANHOLE ⊙ SEWER MANHOLE ⊙ STORM DRAIN </td> <td> <ul style="list-style-type: none"> — RIGHT OF WAY LINE — IRRIGATION LINE — WATER LANE — GAS LAINE ⊙ PROPOSED ANCHOR ⊙ PROPOSED RISER </td> <td> <ul style="list-style-type: none"> — PROPOSED COAXIAL CABLE — PROPOSED FIBER CABLE — PROPOSED DIRECTIONAL BORE — EXISTING CABLE — COUNTY LINE </td> </tr> </table>	<ul style="list-style-type: none"> ⊗ EXISTING POLE □ PROPOSED PEDESTAL ▣ PROPOSED VAULT ⊕ WATER VALVE ⊙ FIBER MARKER ⊙ GAS MARKER ⊙ MANHOLE ⊙ SEWER MANHOLE ⊙ STORM DRAIN 	<ul style="list-style-type: none"> — RIGHT OF WAY LINE — IRRIGATION LINE — WATER LANE — GAS LAINE ⊙ PROPOSED ANCHOR ⊙ PROPOSED RISER 	<ul style="list-style-type: none"> — PROPOSED COAXIAL CABLE — PROPOSED FIBER CABLE — PROPOSED DIRECTIONAL BORE — EXISTING CABLE — COUNTY LINE 		ENGINEERED FOR: 	MADISON COUNTY GUNTER ROAD TRANSPORT FIBER
<ul style="list-style-type: none"> ⊗ EXISTING POLE □ PROPOSED PEDESTAL ▣ PROPOSED VAULT ⊕ WATER VALVE ⊙ FIBER MARKER ⊙ GAS MARKER ⊙ MANHOLE ⊙ SEWER MANHOLE ⊙ STORM DRAIN 	<ul style="list-style-type: none"> — RIGHT OF WAY LINE — IRRIGATION LINE — WATER LANE — GAS LAINE ⊙ PROPOSED ANCHOR ⊙ PROPOSED RISER 	<ul style="list-style-type: none"> — PROPOSED COAXIAL CABLE — PROPOSED FIBER CABLE — PROPOSED DIRECTIONAL BORE — EXISTING CABLE — COUNTY LINE 					
LEGEND: RW - RIGHT OF WAY EOP - EDGE OF PAVEMENT DW - DRIVEWAY PDW - PAVED DRIVEWAY		NOTES: BORE HOLE TO BE FILLED SAME DAY VAULT HOLE TO BE FILLED SAME DAY ALL HOLE TO BE TAMPED AND SODDED		NO SCALE	SHEET 23 OF 26		

MATCH SHEET 23

PROPOSED COMCAST UNDERGROUND
 DIRECTIONAL BORE
 4' MINIMUM DEPTH AT ALL POINTS
 1 24CT FIBER CABLE
 NO OTHER BURIED UTILITIES EXIST

INSTALLATION LENGTH IN RW ON THIS SHEET 1000 FT

NO MATCH SHEET

NO MATCH SHEET

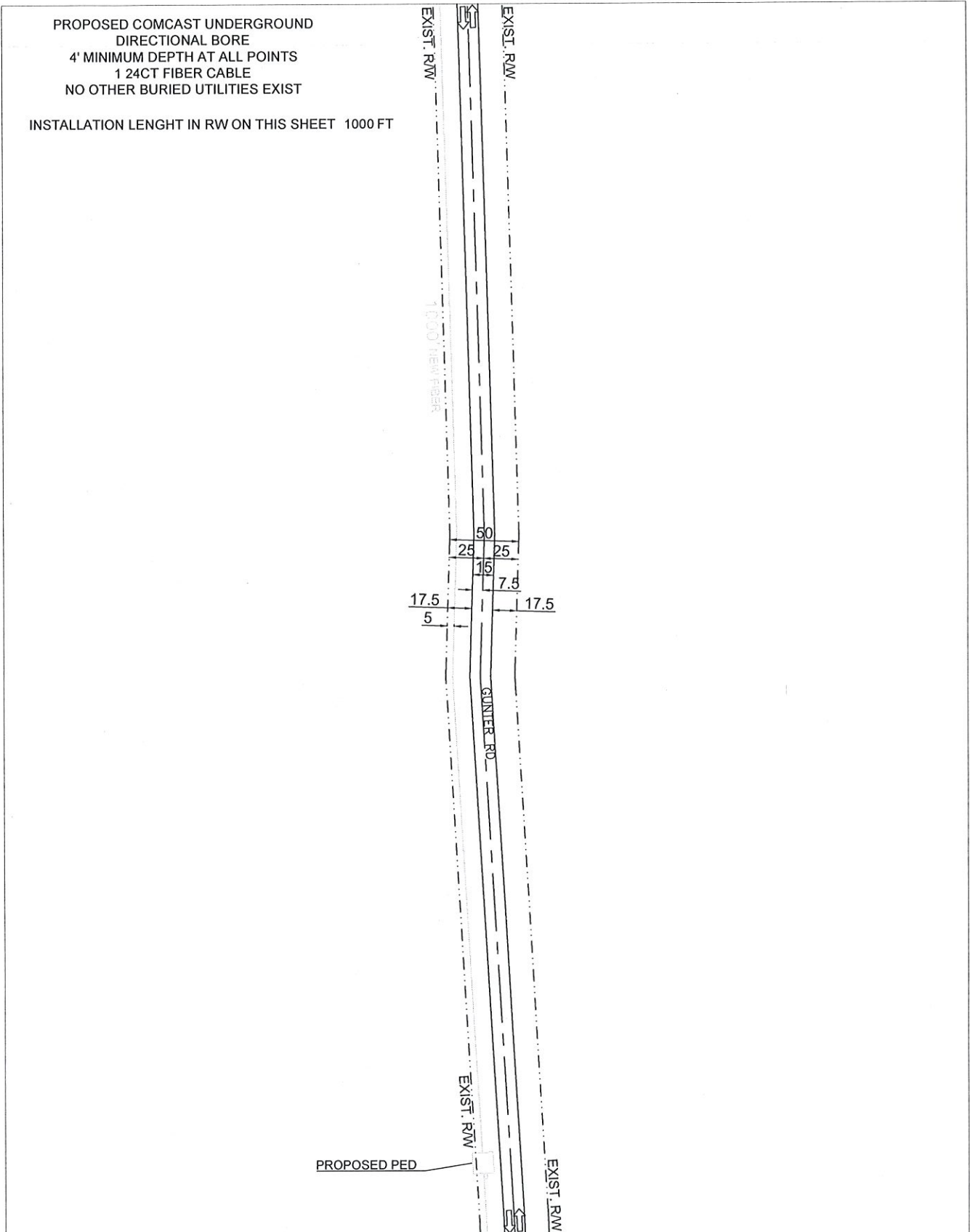

MATCH SHEET 25

PREPARED BY: 	EXISTING POLE PROPOSED PEDESTAL PROPOSED VAULT WATER VALVE FIBER MARKER GAS MARKER MANHOLE SEWER MANHOLE STORM DRAIN	RIGHT OF WAY LINE IRRIGATION LINE WATER LANE GAS LANE PROPOSED ANCHOR PROPOSED RISER	PROPOSED COAXIAL CABLE PROPOSED FIBER CABLE PROPOSED DIRECTIONAL BORE EXISTING CABLE COUNTY LINE		ENGINEERED FOR: 	MADISON COUNTY GUNTER ROAD TRANSPORT FIBER
	LEGEND: RW - RIGHT OF WAY EOP - EDGE OF PAVEMENT DW - DRIVEWAY PDW - PAVED DRIVEWAY	NOTES: BORE HOLE TO BE FILLED SAME DAY VAULT HOLE TO BE FILLED SAME DAY ALL HOLE TO BE TAMPED AND SODDED	NO SCALE SHEET 24 OF 26			

MATCH SHEET 24

PROPOSED COMCAST NEW ATTACHMENT
 18' MINIMUM HEIGHT AT ALL POINTS
 1 24CT FIBER CABLE
 PROPOSED COMCAST UNDERGROUND
 DIRECTIONAL BORE
 4' MINIMUM DEPTH AT ALL POINTS
 1 24CT FIBER CABLE
 NO OTHER BURIED UTILITIES EXIST

INSTALLATION LENGTH IN RW ON THIS SHEET 981 FT

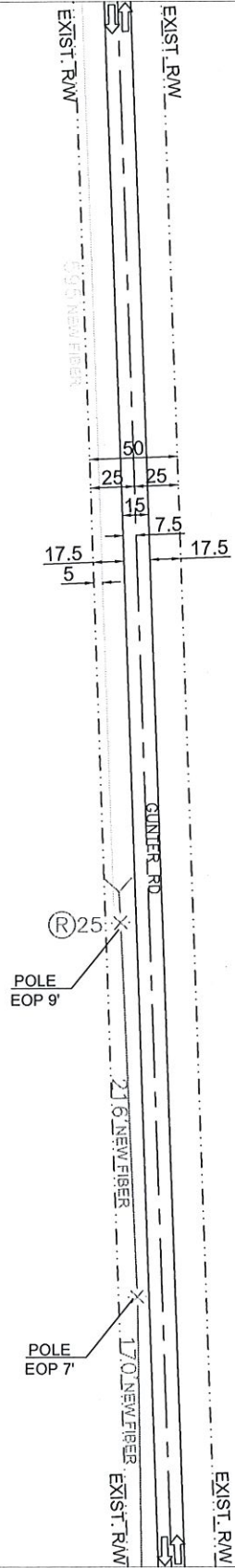

NO MATCH SHEET

NO MATCH SHEET

MATCH SHEET 26

PREPARED BY: 	EXISTING POLE PROPOSED PEDESTAL PROPOSED VAULT WATER VALVE FIBER MARKER GAS MARKER MANHOLE SEWER MANHOLE STORM DRAIN	RIGHT OF WAY LINE IRRIGATION LINE WATER LANE GAS LANE PROPOSED ANCHOR PROPOSED RISER	PROPOSED COAXIAL CABLE PROPOSED FIBER CABLE PROPOSED DIRECTIONAL BORE EXISTING CABLE COUNTY LINE		ENGINEERED FOR: 	MADISON COUNTY GUNTER ROAD TRANSPORT FIBER
	LEGEND: RW - RIGHT OF WAY EOP - EDGE OF PAVEMENT DW - DRIVEWAY POW - PAVED DRIVEWAY	NOTES: BORE HOLE TO BE FILLED SAME DAY VAULT HOLE TO BE FILLED SAME DAY ALL HOLE TO BE TAMPED AND SODDED	NO SCALE SHEET 25 OF 26			

MATCH SHEET 25

PROPOSED COMCAST NEW ATTACHMENT
 18' MINIMUM HEIGHT AT ALL POINTS
 1 24CT FIBER CABLE

INSTALLATION LENGTH IN RW ON THIS SHEET 1000 FT

TOTAL INSTALLATION LENGTH 19637 FT
 AERIAL: 5906 FT
 UG: 13731 FT
 START 32.574845, -89.969682
 END 32.545804, -89.951865

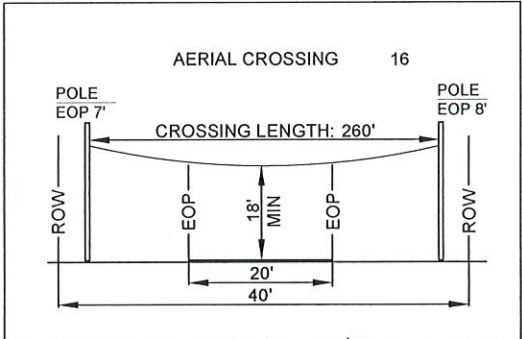
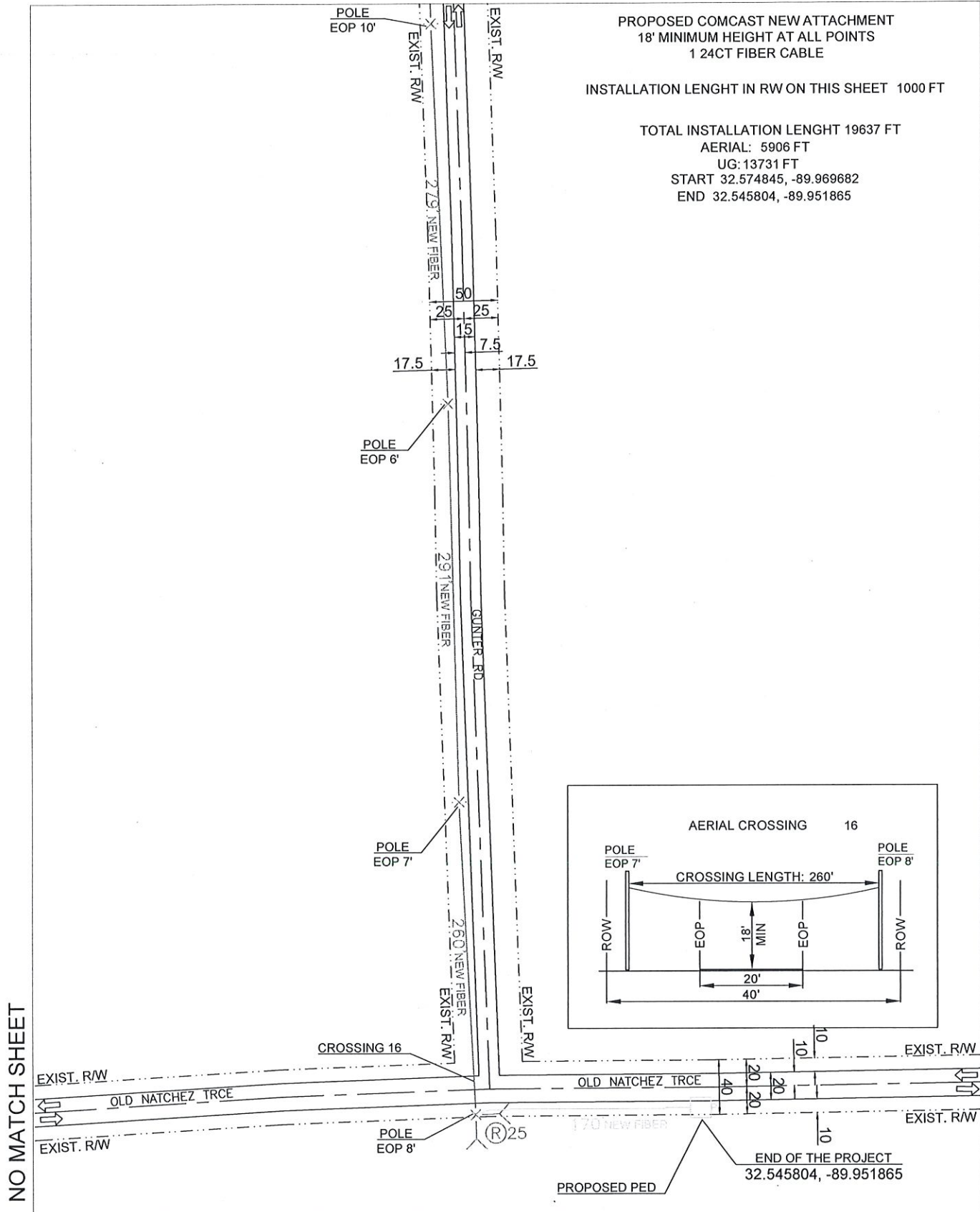

NO MATCH SHEET

NO MATCH SHEET

NO MATCH SHEET

PREPARED BY: 	EXISTING POLE PROPOSED PEDESTAL PROPOSED VAULT WATER VALVE FIBER MARKER GAS MARKER MANHOLE SEWER MANHOLE STORM DRAIN	RIGHT OF WAY LINE IRRIGATION LINE WATER LANE GAS LAINE PROPOSED ANCHOR PROPOSED RISER	PROPOSED COAXIAL CABLE PROPOSED FIBER CABLE PROPOSED DIRECTIONAL BORE EXISTING CABLE COUNTY LINE		ENGINEERED FOR: 	MADISON COUNTY GUNTER ROAD OLD NATCHEZ TRCE TRANSPORT FIBER
	LEGEND: RW - RIGHT OF WAY EOP - EDGE OF PAVEMENT DW - DRIVEWAY PDW - PAVED DRIVEWAY	NOTES: BORE HOLE TO BE FILLED SAME DAY VAULT HOLE TO BE FILLED SAME DAY ALL HOLE TO BE TAMPED AND SODDED	NO SCALE SHEET 26 OF 26			